

Lower Thames Crossing

2.3 Crown Land Plans Volume B (Sheets 1 to 20)

APFP Regulation 5(2)(n)

Infrastructure Planning (Applications:
Prescribed Forms and Procedure)
Regulations 2009

Volume 2

DATE: October 2022

Planning Inspectorate Scheme Ref: TR010032
Application Document Ref: TR010032/APP/2.3

VERSION: 1.0

**(THIS PAGE IS INTENTIONALLY LEFT
BLANK)**

Lower Thames Crossing

2.3 Crown Land Plans

List of contents

	Page number
1 Introduction	1
1.1 Purpose of this document	1
2 Scope and format of the Crown Land Plans	2
3 Schedule of Plans included in this application	5

1 Introduction

1.1 Purpose of this document

- 1.1.1 National Highways (the Applicant) has submitted an application under section 37 of the Planning Act 2008 for an order to grant development consent for the A122 Lower Thames Crossing (the Project).
- 1.1.2 This document is part of a suite of documents which accompanies the application to grant development consent. A full description of all the Application Documents is provided in the Introduction to the Application (Application Document 1.3) which also accompanies the application.
- 1.1.3 This document is included in the application to comply with Regulation 5(2)(n) of the Infrastructure Planning (Applications: Prescribed Forms and Procedures) Regulations 2009, which requires:
- 5(2)(n) “where applicable, a plan with any accompanying information identifying any Crown land”.*
- 1.1.4 Regulation 5(4) requires that “Where a plan comprises three or more separate sheets a key plan must be provided showing the relationship between the different sheets”.
- 1.1.5 Accordingly, a key plan is submitted as part of the application to identify the location of the Project in its wider geographical context.
- 1.1.6 For the avoidance of doubt, any land held by the Applicant no longer constitutes Crown Land. A transfer scheme made pursuant to the Infrastructure Act 2015 states that the “Highways Agency Designated Undertaking” which is defined as the property and rights which were held for the purposes of Relevant Highway Agency Purposes (activities carried out by the Highways Agency or those which concerned functions relating to the highways) is transferred to the Applicant. This includes, for example, all highways in England previously under the jurisdiction of the Highways Agency unless they have been specifically excluded. As the Applicant is not a government department nor does it hold said interests on trust, these plots are not considered Crown Land (as per section 227 of the Planning Act 2008).
- 1.1.7 The Crown Estate has confirmed that they do not consider land subject to escheat to constitute Crown Land for the purposes of the Planning Act 2008.
- 1.1.8 In this plan set “the Order limits” means the “limits of land to be acquired or used permanently or temporarily within which the authorised development may be carried out (see article 2 of the Order).

2 Scope and format of the Crown Land Plans

- 2.1.1 To ensure sufficient detail and clarity of information, the Crown Land Plans, sheets 1 to 49 have been prepared at a scale of 1:2,500. The key plan uses a smaller scale than that prescribed in Regulation 5(3) of the 2009 Regulations but only so that the Project can be represented in a single sheet plan.
- 2.1.2 The Applicant has adopted the same consistent approach for the Crown Land Plans as has been used for the:
- Land Plans (Application Document 2.2),
 - the Special Category Land Plans (Application Document 2.4),
 - the General Arrangement (Application Document 2.5),
 - the Works Plans (Application Document 2.6),
 - the Rights of Way and Access Plans (Application Document 2.7),
 - the Streets Subject to Temporary Restrictions of Use (Application Document 2.8),
 - the Traffic Regulation Measures (Application Document 2.10),
 - the Drainage Plans (Application Document 2.16).
- 2.1.3 The sheet layouts are the same for each of the aforementioned sets. This is intended to help interested parties understand the inter-relationship between the different sets of plans and to help illustrate the design of the Project more clearly.
- 2.1.4 Each plot of land shown on the Crown Land Plan has been given a unique reference, which corresponds with the referencing or plot numbering used in the Book of Reference (Application Document 4.2). The first number relates to the Crown Land Plan sheet on which the plot is located while the second number is used to distinguish between the plots.
- 2.1.5 In accordance with good practice, the plots have generally been numbered from west to east on each sheet following the sheet numbering system. The Order Limits are depicted on the Land Plans with a thicker red line to ensure that they are clearly distinguishable from the red lines used to depict plot boundaries.
- 2.1.6 Land shaded in pink with blue hatching indicates Crown Land that is known or presumed to be a land interest of the Secretary of State for Transport which is to be permanently acquired.
- 2.1.7 Land shaded in green with blue hatching indicates Crown Land that is known or presumed to be a land interest of the Secretary of State for Transport which is to be temporarily acquired.
- 2.1.8 Land shaded in blue with blue hatching includes Crown Land that is known or presumed to be a land interest of the Secretary of State for Transport that is to be used temporarily and over which rights are to be acquired and includes land

belonging to a third party where there will be a continuing need to re-enter the land after completion of the works.

- 2.1.9 Land shaded in pink with green hatching indicates Crown Land that is known or presumed to be a land interest of the Secretary of State for Environment, Food and Rural Affairs which is to be permanently acquired.
- 2.1.10 Land shaded in green with green hatching indicates Crown Land that is known or presumed to be a land interest of the Secretary of State for Environment, Food and Rural Affairs which is to be temporarily acquired.
- 2.1.11 Land shaded in blue with green hatching indicates Crown Land that is known or presumed to be a land interest of the Secretary of State for Environment, Food and Rural Affairs which is to be used temporarily and over which rights are to be acquired.
- 2.1.12 Land shaded in pink with purple hatching indicates Crown Land that is known or presumed to be a land interest of The Crown Estate (bona vacantia) which is to be to be permanently acquired.
- 2.1.13 Land shaded in green with purple hatching indicates Crown Land that is known or presumed to be a land interest of The Crown Estate (bona vacantia) which is to be temporarily acquired.
- 2.1.14 Land shaded in blue with purple hatching indicates Crown Land that is known or presumed to be a land interest of The Crown Estate (bona vacantia) which is to be used temporarily and over which rights are to be acquired.
- 2.1.15 Land shaded in pink with dark red hatching indicates Crown Land that is known or presumed to be a land interest of The Duchy of Lancaster (bona vacantia) which is to be to be permanently acquired.
- 2.1.16 Land shaded in green with dark red hatching indicates Crown Land that is known or presumed to be a land interest of The Duchy of Lancaster (bona vacantia) which is to be temporarily acquired.
- 2.1.17 Land shaded in blue with dark red hatching indicates Crown Land that is known or presumed to be a land interest of The Duchy of Lancaster (bona vacantia) which is to be used temporarily and over which rights are to be acquired.
- 2.1.18 Land shaded in pink with orange hatching indicates Crown Land that is known or presumed to be a land interest of the Secretary of State for Health and Social Care which is to be to be permanently acquired.
- 2.1.19 Land shaded in green with orange hatching indicates Crown Land that is known or presumed to be a land interest of the Secretary of State for Health and Social Care which is to be temporarily acquired.
- 2.1.20 Land shaded in blue with orange hatching indicates Crown Land that is known or presumed to be a land interest of the Secretary of State for Health and Social Care which is to be used temporarily and over which rights are to be acquired.
- 2.1.21 Land shaded in pink with green and blue cross-hatching indicates Crown Land that is known or presumed to be a land interest of the Secretary of State for Environment, Food and Rural Affairs and the Secretary of State for Transport that is to be permanently acquired.

- 2.1.22 Land shaded in green with green and blue cross-hatching indicates Crown Land that is known or presumed to be a land interest of the Secretary of State for Environment, Food and Rural Affairs and the Secretary of State for Transport that is to be temporarily acquired.
- 2.1.23 Land shaded in blue with green and blue cross-hatching indicates Crown Land that is known or presumed to be a land interest of the Secretary of State for Environment, Food and Rural Affairs and the Secretary of State for Transport that is to be used temporarily and over which rights are to be acquired.
- 2.1.24 Land shaded in green with blue and purple cross-hatching indicates Crown Land that is known or presumed to be a land interest of the Secretary of State for Transport and The Crown Estate (bona vacantia) that is to be temporarily acquired.
- 2.1.25 Land shaded in pink with green and orange cross-hatching indicates Crown Land that is known or presumed to be a land interest of the Secretary of State for Environment, Food and Rural Affairs and the Secretary of State for Health and Social Care that is to be permanently acquired.

3 Schedule of Plans included in this application

Document Title	Document Number	Revision
CROWN LAND PLANS REGULATION 5(2)(n) KEY PLAN	TR010032/APP/2.3	P01
CROWN LAND PLANS REGULATION 5(2)(n) SHEET 1 OF 49	TR010032/APP/2.3	P01
CROWN LAND PLANS REGULATION 5(2)(n) SHEET 2 OF 49	TR010032/APP/2.3	P01
CROWN LAND PLANS REGULATION 5(2)(n) SHEET 3 OF 49	TR010032/APP/2.3	P01
CROWN LAND PLANS REGULATION 5(2)(n) SHEET 4 OF 49	TR010032/APP/2.3	P01
CROWN LAND PLANS REGULATION 5(2)(n) SHEET 5 OF 49	TR010032/APP/2.3	P01
CROWN LAND PLANS REGULATION 5(2)(n) SHEET 6 OF 49	TR010032/APP/2.3	P01
CROWN LAND PLANS REGULATION 5(2)(n) SHEET 7 OF 49	TR010032/APP/2.3	P01
CROWN LAND PLANS REGULATION 5(2)(n) SHEET 8 OF 49	TR010032/APP/2.3	P01
CROWN LAND PLANS REGULATION 5(2)(n) SHEET 9 OF 49	TR010032/APP/2.3	P01
CROWN LAND PLANS REGULATION 5(2)(n) SHEET 10 OF 49	TR010032/APP/2.3	P01
CROWN LAND PLANS REGULATION 5(2)(n) SHEET 11 OF 49	TR010032/APP/2.3	P01
CROWN LAND PLANS REGULATION 5(2)(n) SHEET 12 OF 49	TR010032/APP/2.3	P01

Document Title	Document Number	Revision
CROWN LAND PLANS REGULATION 5(2)(n) SHEET 13 OF 49	TR010032/APP/2.3	P01
CROWN LAND PLANS REGULATION 5(2)(n) SHEET 14 OF 49	TR010032/APP/2.3	P01
CROWN LAND PLANS REGULATION 5(2)(n) SHEET 15 OF 49	TR010032/APP/2.3	P01
CROWN LAND PLANS REGULATION 5(2)(n) SHEET 16 OF 49	TR010032/APP/2.3	P01
CROWN LAND PLANS REGULATION 5(2)(n) SHEET 17 OF 49	TR010032/APP/2.3	P01
CROWN LAND PLANS REGULATION 5(2)(n) SHEET 18 OF 49	TR010032/APP/2.3	P01
CROWN LAND PLANS REGULATION 5(2)(n) SHEET 19 OF 49	TR010032/APP/2.3	P01
CROWN LAND PLANS REGULATION 5(2)(n) SHEET 20 OF 49	TR010032/APP/2.3	P01
CROWN LAND PLANS REGULATION 5(2)(n) SHEET 21 OF 49	TR010032/APP/2.3	P01
CROWN LAND PLANS REGULATION 5(2)(n) SHEET 22 OF 49	TR010032/APP/2.3	P01
CROWN LAND PLANS REGULATION 5(2)(n) SHEET 23 OF 49	TR010032/APP/2.3	P01
CROWN LAND PLANS REGULATION 5(2)(n) SHEET 24 OF 49	TR010032/APP/2.3	P01
CROWN LAND PLANS REGULATION 5(2)(n) SHEET 25 OF 49	TR010032/APP/2.3	P01
CROWN LAND PLANS REGULATION 5(2)(n) SHEET 26 OF 49	TR010032/APP/2.3	P01

Document Title	Document Number	Revision
CROWN LAND PLANS REGULATION 5(2)(n) SHEET 27 OF 49	TR010032/APP/2.3	P01
CROWN LAND PLANS REGULATION 5(2)(n) SHEET 28 OF 49	TR010032/APP/2.3	P01
CROWN LAND PLANS REGULATION 5(2)(n) SHEET 29 OF 49	TR010032/APP/2.3	P01
CROWN LAND PLANS REGULATION 5(2)(n) SHEET 30 OF 49	TR010032/APP/2.3	P01
CROWN LAND PLANS REGULATION 5(2)(n) SHEET 31 OF 49	TR010032/APP/2.3	P01
CROWN LAND PLANS REGULATION 5(2)(n) SHEET 32 OF 49	TR010032/APP/2.3	P01
CROWN LAND PLANS REGULATION 5(2)(n) SHEET 33 OF 49	TR010032/APP/2.3	P01
CROWN LAND PLANS REGULATION 5(2)(n) SHEET 34 OF 49	TR010032/APP/2.3	P01
CROWN LAND PLANS REGULATION 5(2)(n) SHEET 35 OF 49	TR010032/APP/2.3	P01
CROWN LAND PLANS REGULATION 5(2)(n) SHEET 36 OF 49	TR010032/APP/2.3	P01
CROWN LAND PLANS REGULATION 5(2)(n) SHEET 37 OF 49	TR010032/APP/2.3	P01
CROWN LAND PLANS REGULATION 5(2)(n) SHEET 38 OF 49	TR010032/APP/2.3	P01
CROWN LAND PLANS REGULATION 5(2)(n) SHEET 39 OF 49	TR010032/APP/2.3	P01
CROWN LAND PLANS REGULATION 5(2)(n) SHEET 40 OF 49	TR010032/APP/2.3	P01

Document Title	Document Number	Revision
CROWN LAND PLANS REGULATION 5(2)(n) SHEET 41 OF 49	TR010032/APP/2.3	P01
CROWN LAND PLANS REGULATION 5(2)(n) SHEET 42 OF 49	TR010032/APP/2.3	P01
CROWN LAND PLANS REGULATION 5(2)(n) SHEET 43 OF 49	TR010032/APP/2.3	P01
CROWN LAND PLANS REGULATION 5(2)(n) SHEET 44 OF 49	TR010032/APP/2.3	P01
CROWN LAND PLANS REGULATION 5(2)(n) SHEET 45 OF 49	TR010032/APP/2.3	P01
CROWN LAND PLANS REGULATION 5(2)(n) SHEET 46 OF 49	TR010032/APP/2.3	P01
CROWN LAND PLANS REGULATION 5(2)(n) SHEET 47 OF 49	TR010032/APP/2.3	P01
CROWN LAND PLANS REGULATION 5(2)(n) SHEET 48 OF 49	TR010032/APP/2.3	P01
CROWN LAND PLANS REGULATION 5(2)(n) SHEET 49 OF 49	TR010032/APP/2.3	P01

**NO DESIGN INFORMATION ON THIS SHEET
FOR CROWN LAND PLANS**

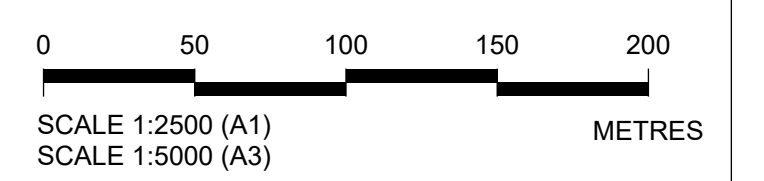

P01	S1	24/08/2022	Issued for Information	LS	AA	TG
Rev	Status	Rev. Date	Purpose of revision	Drawn	Chck'd	Apprv'd

1. All dimensions are in metres unless stated otherwise.
 2. These Land Plans should be read in conjunction with other plans and documents in the Development Consent Order application (TR020032/APP/3.1), in particular the Book of Reference (TR020032/APP/4.2).
 3. All easements, servitudes and private rights in land are proposed to be extinguished on land shown coloured pink on these land plans. All easements, servitudes and private rights in land are proposed to be extinguished, so far as their continued exercise would be inconsistent with the exercise of the rights or restrictions proposed to be acquired by the undertaker on land shown coloured blue on these land plans.
 4. All easements, servitudes and private rights are proposed to be suspended while the undertaker is in temporary possession of the land shown coloured green on these land plans.
 5. The number labels relate to plot numbers. Please refer to the Book of Reference for more information about these plots, including the approximate area of each plot. Plot numbers include a reference to the relevant sheet of the Land Plans. In this numbering convention, a plot number comprises the sheet number followed by the actual plot number, e.g. Plot 01-24, where '01' is the sheet number.

Legend
 Order Limits
 Local Authority Boundary

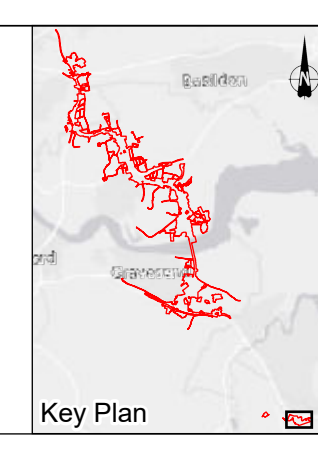

Client
 national highways

Project
LOWER THAMES CROSSING

Status	DCO Application	Original Size	A1	Revision	P01
Application Document Number	TR010032/APP/2.3	Scale	1:2,500		
Drawing Title	CROWN LAND PLANS REGULATION 5(2)(n) SHEET 1 OF 49				
Drawing Number	HE450039-CJV-BOP-ZZZ_BD000000_-DR-BL-20001				

**NO DESIGN INFORMATION ON THIS SHEET
FOR CROWN LAND PLANS**

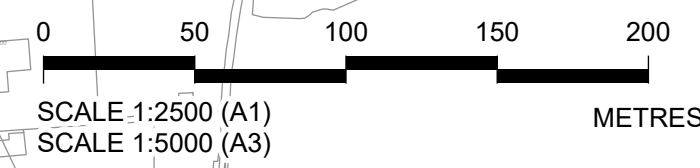

Crown copyright material is reproduced with the permission of Land Registry under delegated authority from the Controller of HMSO. This material was last updated in July 2022 and may not be copied, distributed, sold or published without the formal permission of Land Registry. Contains Ordnance Survey data. © Crown copyright and database rights 2022. Ordnance Survey 100030549

1. All dimensions are in metres unless stated otherwise.
2. These Land Plans should be read in conjunction with other plans and documents in the Development Consent Order application (TR020032/APP/3.1), in particular the Book of Reference (TR020032/APP/4.2).
3. All easements, servitudes and private rights in land are proposed to be extinguished on land shown coloured pink on these land plans. All easements, servitudes and private rights in land are proposed to be extinguished, so far as their continued exercise would be inconsistent with the exercise of the rights or restrictions proposed to be acquired by the undertaker on land shown coloured blue on these land plans.
4. All easements, servitudes and private rights are proposed to be suspended while the undertaker is in temporary possession of the land shown coloured green on these land plans.
5. The number labels relate to plot numbers. Please refer to the Book of Reference for more information about these plots, including the approximate area of each plot. Plot numbers include a reference to the relevant sheet of the Land Plans. In this numbering convention, a plot number comprises the sheet number followed by the actual plot number, e.g: Plot 01-24, where '01' is the sheet number.

Legend
 Order Limits
 Local Authority Boundary

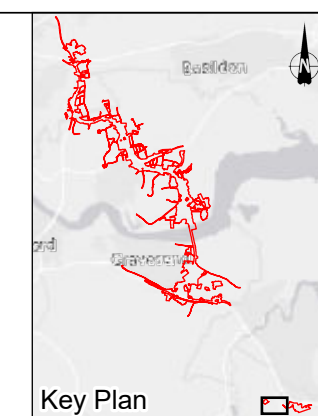

Client
national highways

Project
LOWER THAMES CROSSING

Status DCO Application	Original Size A1
Application Document Number TR010032/APP/2.3	Scale 1:2,500
Drawing Title CROWN LAND PLANS REGULATION 5(2)(n) SHEET 2 OF 49	
Drawing Number HE450039-CJV-BOP-ZZZ_BD000000_-DR-BL-20002	

P01	S1	24/08/2022	Issued for Information	LS	AA	TG
Rev	Status	Rev. Date	Purpose of revision	Drawn	Chck'd	Apprv'd



Local Authority:
Gravesham Borough Council

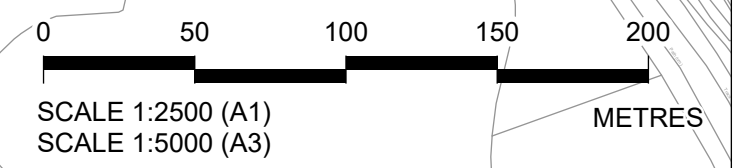
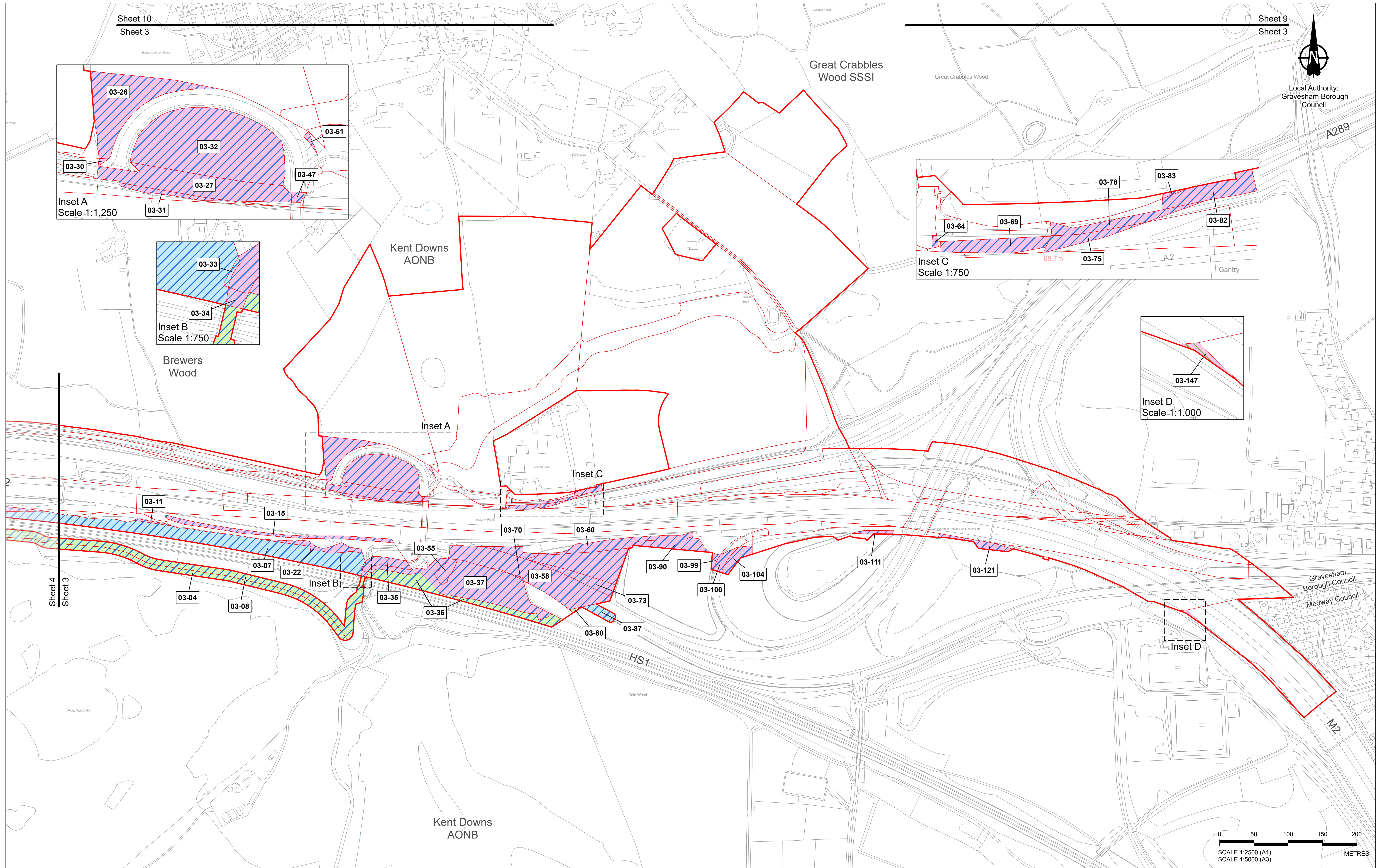
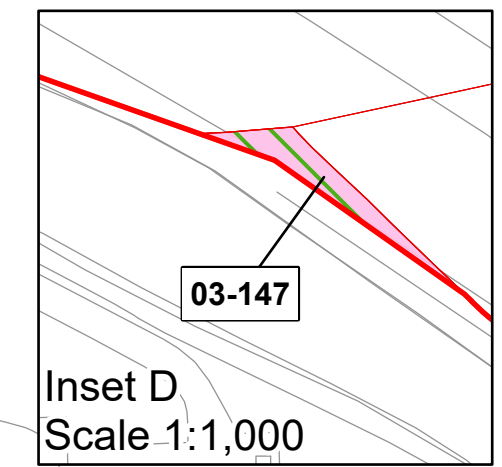
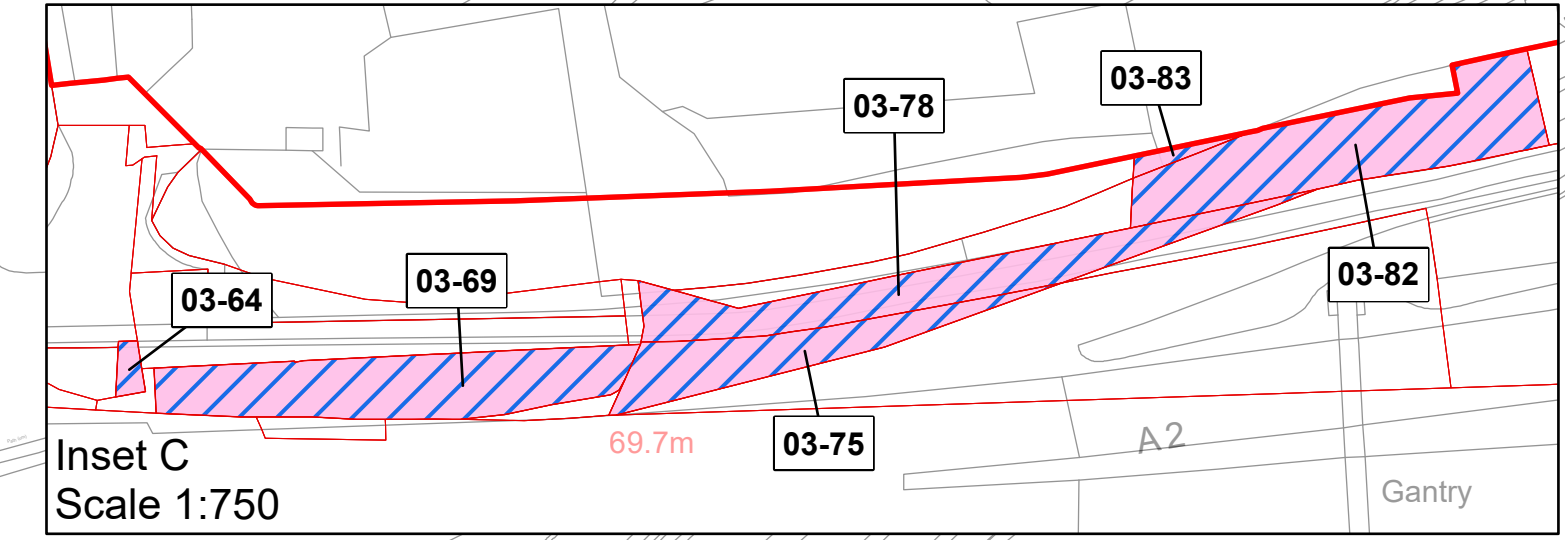
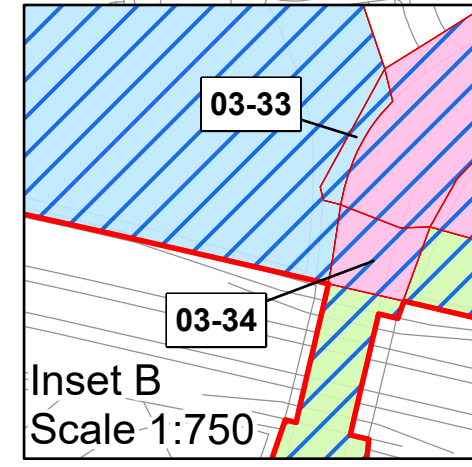
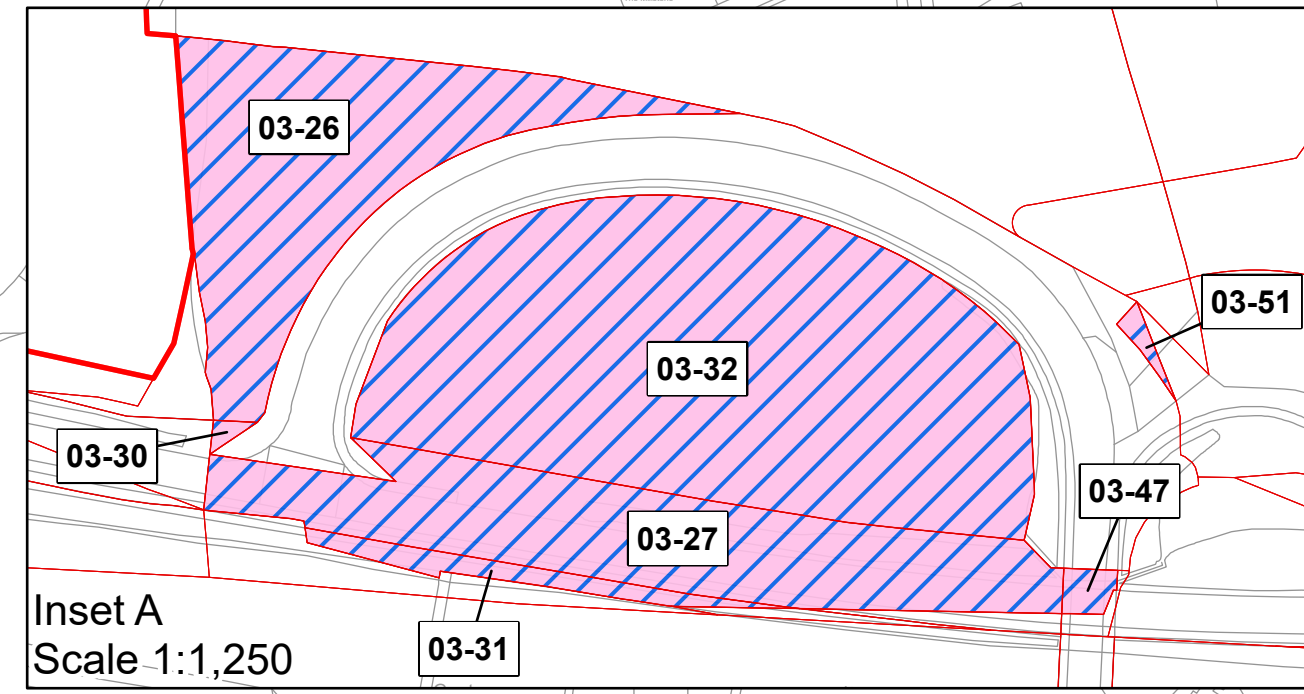

Crown copyright material is reproduced with the permission of Land Registry under delegated authority from the Controller of HMSO. This material was last updated in July 2022 and may not be copied, distributed, sold or published without the formal permission of Land Registry. Contains Ordnance Survey data. © Crown copyright and database rights 2022. Ordnance Survey 100030549

P01	S1	24/08/2022	Issued for Information	LS	AA	TG
Rev	Status	Rev. Date	Purpose of revision	Drawn	Chck'd	Apprv'd

1. All dimensions are in metres unless stated otherwise.
2. These Land Plans should be read in conjunction with other plans and documents in the Development Consent Order application (TR020032/APP/3.1), in particular the Book of Reference (TR020032/APP/4.2).
3. All easements, servitudes and private rights in land are proposed to be extinguished on land shown coloured pink on these land plans. All easements, servitudes and private rights in land are proposed to be extinguished, so far as their continued exercise would be inconsistent with the exercise of the rights or restrictions proposed to be acquired by the undertaker on land shown coloured blue on these land plans.
4. All easements, servitudes and private rights are proposed to be suspended while the undertaker is in temporary possession of the land shown coloured green on these land plans.
5. The number labels relate to plot numbers. Please refer to the Book of Reference for more information about these plots, including the approximate area of each plot. Plot numbers include a reference to the relevant sheet of the Land Plans. In this numbering convention, a plot number comprises the sheet number followed by the actual plot number, e.g: Plot 01-24, where '01' is the sheet number.

- Legend**
- Order Limits
 - Local Authority Boundary
 - Permanent Acquisition of Land - The Secretary of State for Transport
 - Temporary Possession of Land - The Secretary of State for Transport
 - Temporary Possession of Land and Permanent Acquisition of Rights - The Secretary of State for Transport
 - Permanent Acquisition of Land - The Secretary of State for Environment Food and Rural Affairs

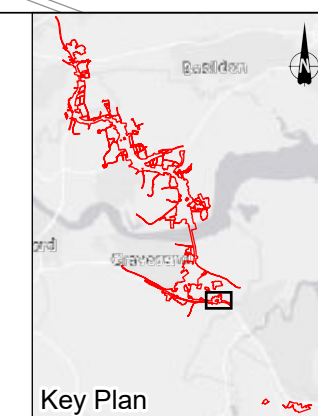

Client:

Project: **LOWER THAMES CROSSING**

Status	DCO Application	Original Size	A1	Revision	P01
Application Document Number	TR010032/APP/2.3	Scale	1:2,500		
Drawing Title	CROWN LAND PLANS REGULATION 5(2)(n) SHEET 3 OF 49				
Drawing Number	HE450039-CJV-BOP-ZZZ_BD000000_-DR-BL-20003				

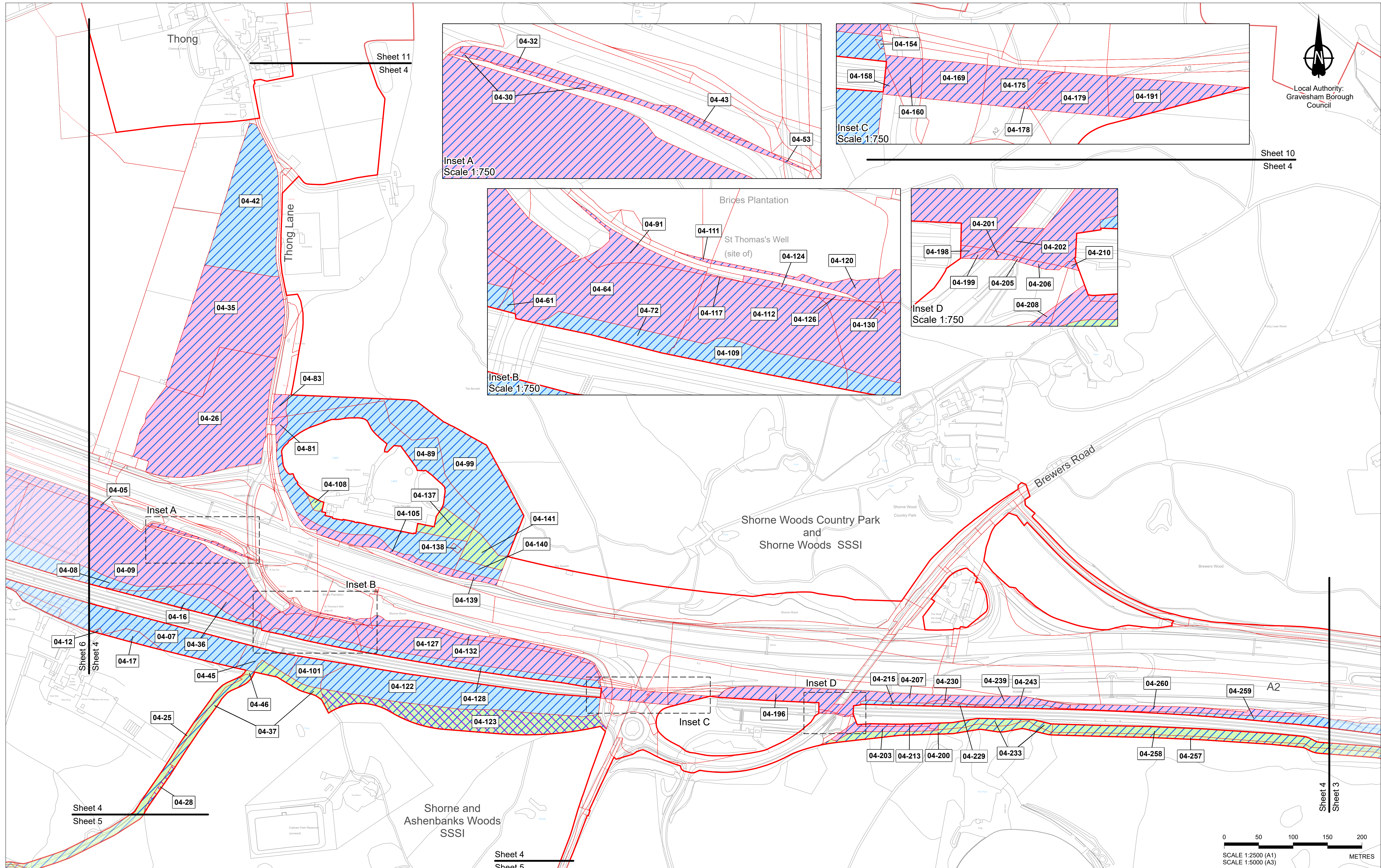

Sheet 10
Sheet 4

Sheet 11
Sheet 4

Inset A
Scale 1:750

Inset C
Scale 1:750

Inset B
Scale 1:750

Inset D
Scale 1:750

Inset A

Inset B

Inset D

Inset C

Sheet 4
Sheet 5

Sheet 4
Sheet 5

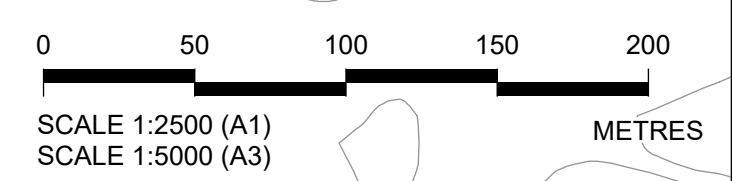

Crown copyright material is reproduced with the permission of Land Registry under delegated authority from the Controller of HMSO. This material was last updated in July 2022 and may not be copied, distributed, sold or published without the formal permission of Land Registry. Contains Ordnance Survey data. © Crown copyright and database rights 2022. Ordnance Survey 1000305649						
P01	S1	24/08/2022	Issued for Information	LS	AA	TG
Rev	Status	Rev. Date	Purpose of revision	Drawn	Chck'd	Apprv'd

1. All dimensions are in metres unless stated otherwise.
2. These Land Plans should be read in conjunction with other plans and documents in the Development Consent Order application (TR020032/APP/3.1), in particular the Book of Reference (TR020032/APP/4.2).
3. All easements, servitudes and private rights in land are proposed to be extinguished on land shown coloured pink on these land plans. All easements, servitudes and private rights in land are proposed to be extinguished, so far as their continued exercise would be inconsistent with the exercise of the rights or restrictions proposed to be acquired by the undertaker on land shown coloured blue on these land plans.
4. All easements, servitudes and private rights are proposed to be suspended while the undertaker is in temporary possession of the land shown coloured green on these land plans.
5. The number labels relate to plot numbers. Please refer to the Book of Reference for more information about these plots, including the approximate area of each plot. Plot numbers include a reference to the relevant sheet of the Land Plans. In this numbering convention, a plot number comprises the sheet number followed by the actual plot number, e.g: Plot 01-24, where '01' is the sheet number.

- Legend**
- Order Limits
 - Local Authority Boundary
 - Permanent Acquisition of Land - The Secretary of State for Transport
 - Temporary Possession of Land - The Secretary of State for Transport
 - Temporary Possession of Land and Permanent Acquisition of Rights - The Secretary of State for Transport
 - Temporary Possession of Land - The Secretary of State for Transport and The Crown Estate

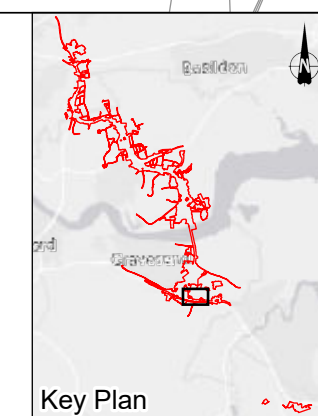

Client
national highways

Project
LOWER THAMES CROSSING

Status	DCO Application	Original Size	A1	Revision	P01
Application Document Number	TR010032/APP/2.3	Scale	1:2,500		
Drawing Title	CROWN LAND PLANS REGULATION 5(2)(n) SHEET 4 OF 49				
Drawing Number	HE450039-CJV-BOP-ZZZ_BD000000_-DR-BL-20004				

Sheet 6
Sheet 5

05-01

Sheet 4
Sheet 5

05-04

Sheet 4
Sheet 5

Inset A

Shorne and
Ashenbanks Woods
SSSI

Local Authority:
Gravesham Borough
Council

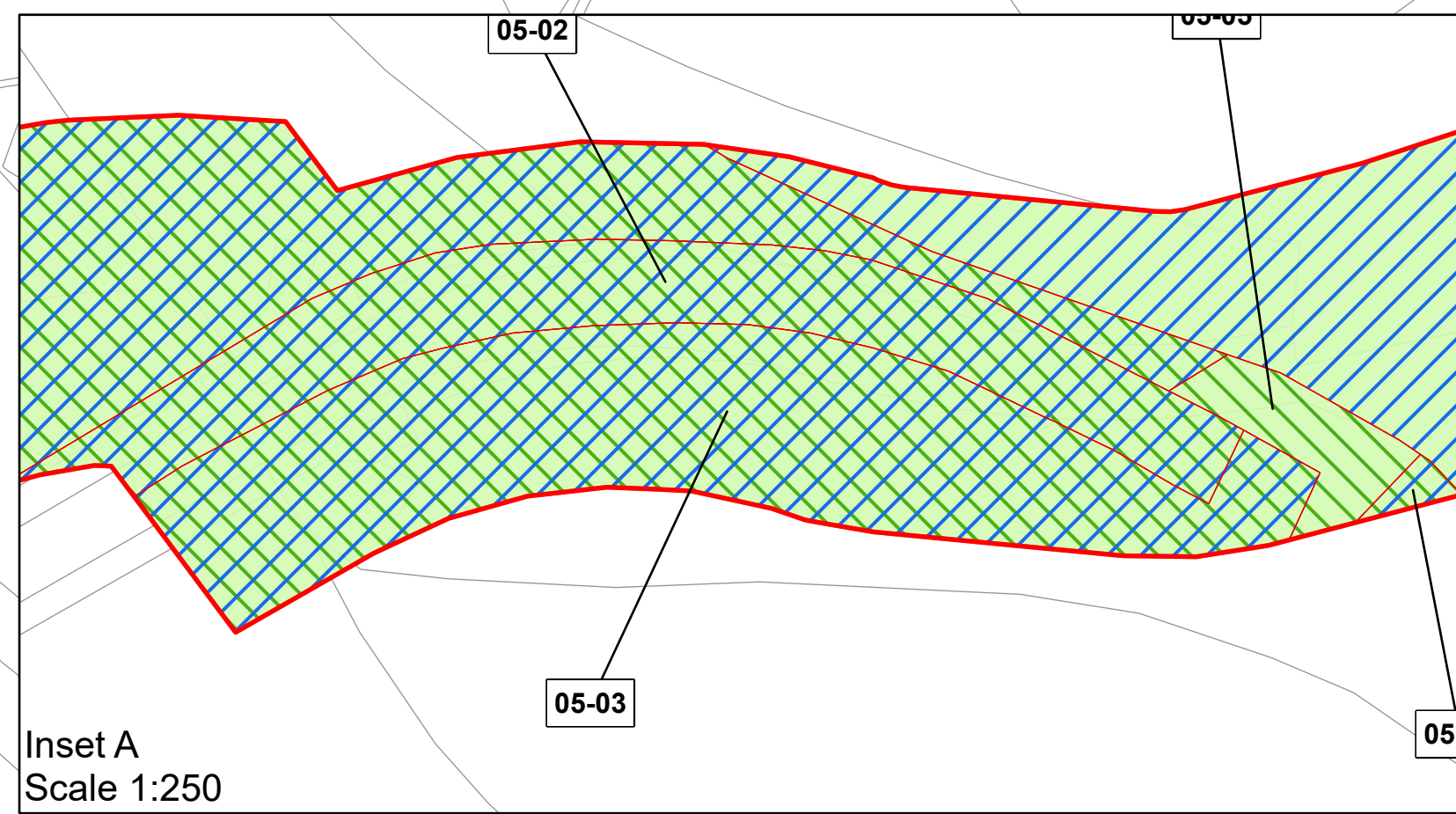

Inset A
Scale 1:250

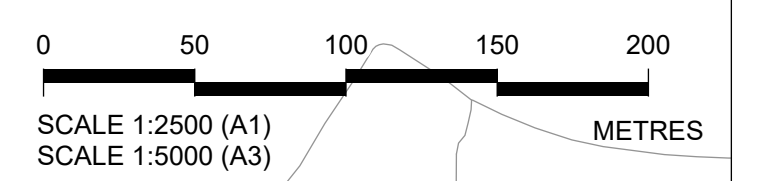

Crown copyright material is reproduced with the permission of Land Registry under delegated authority from the Controller of HMSO. This material was last updated in July 2022 and may not be copied, distributed, sold or published without the formal permission of Land Registry. Contains Ordnance Survey data. © Crown copyright and database rights 2022. Ordnance Survey 100030649

1. All dimensions are in metres unless stated otherwise.
2. These Land Plans should be read in conjunction with other plans and documents in the Development Consent Order application (TR020032/APP/3.1), in particular the Book of Reference (TR020032/APP/4.2).
3. All easements, servitudes and private rights in land are proposed to be extinguished on land shown coloured pink on these land plans. All easements, servitudes and private rights in land are proposed to be extinguished, so far as their continued exercise would be inconsistent with the exercise of the rights or restrictions proposed to be acquired by the undertaker on land shown coloured blue on these land plans.
4. All easements, servitudes and private rights are proposed to be suspended while the undertaker is in temporary possession of the land shown coloured green on these land plans.
5. The number labels relate to plot numbers. Please refer to the Book of Reference for more information about these plots, including the approximate area of each plot. Plot numbers include a reference to the relevant sheet of the Land Plans. In this numbering convention, a plot number comprises the sheet number followed by the actual plot number, e.g: Plot 01-24, where '01' is the sheet number.

- Legend**
- Order Limits
 - Local Authority Boundary
 - Temporary Possession of Land - The Secretary of State for Transport
 - Temporary Possession of Land - The Secretary of State for Environment Food and Rural Affairs
 - Temporary Possession of Land - The Secretary of State for Transport and The Secretary of State for Environment Food and Rural Affairs

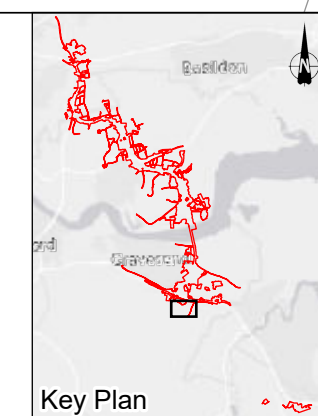

Client

Project

LOWER THAMES CROSSING

Status	DCO Application	Original Size	A1	Revision	P01
Application Document Number	TR010032/APP/2.3	Scale	1:2,500		
Drawing Title	CROWN LAND PLANS REGULATION 5(2)(n) SHEET 5 OF 49				
Drawing Number	HE450039-CJV-BOP-ZZZ_BD000000_-DR-BL-20005				

P01	S1	24/08/2022	Issued for Information	LS	AA	TG
Rev	Status	Rev. Date	Purpose of revision	Drawn	Check'd	Apprv'd

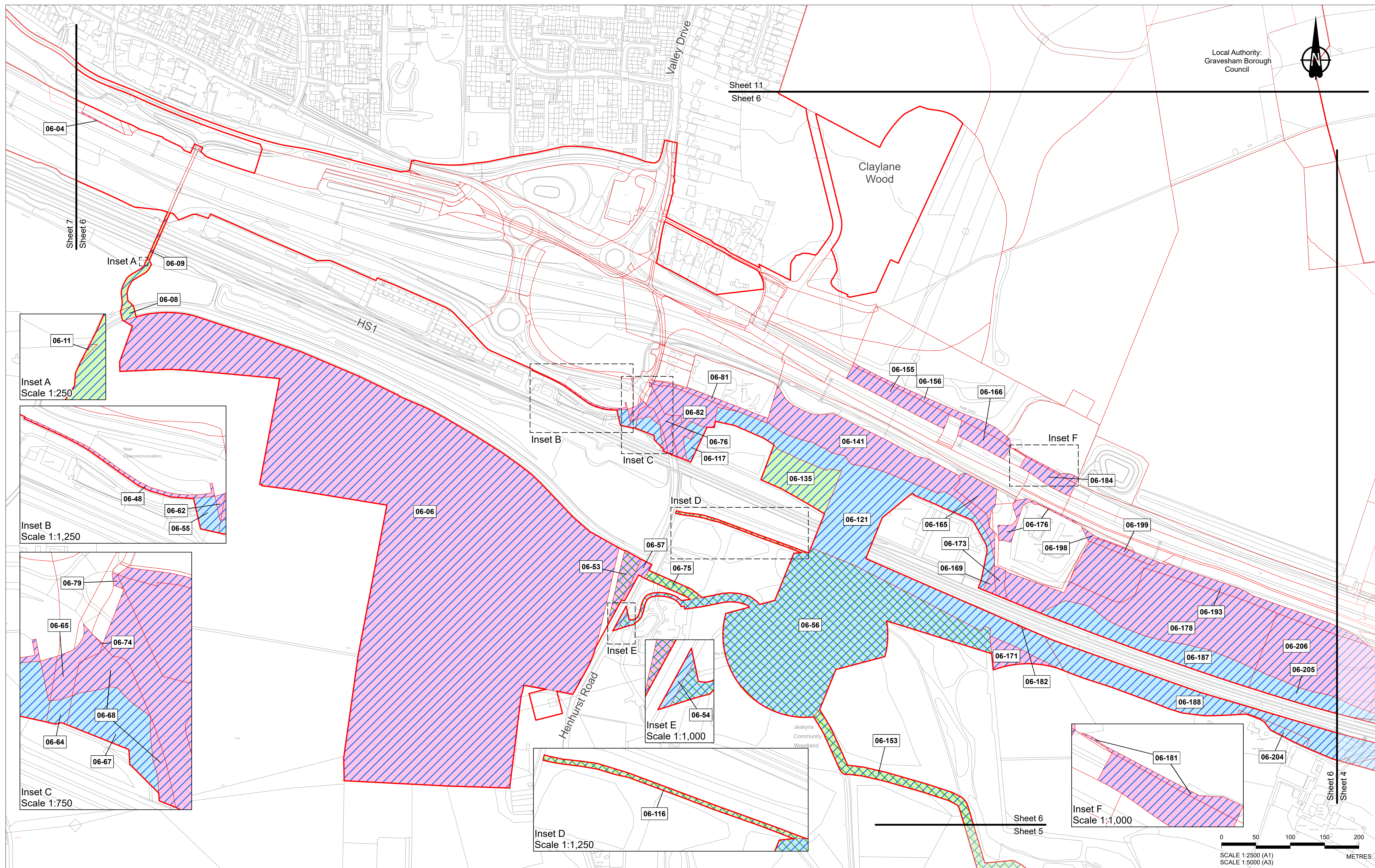
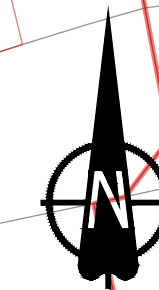

Crown copyright material is reproduced with the permission of Land Registry under delegated authority from the Controller of HMSO. This material was last updated in July 2022 and may not be copied, distributed, sold or published without the formal permission of Land Registry. Contains Ordnance Survey data. © Crown copyright and database rights 2022. Ordnance Survey 1000305649

P01	S1	24/08/2022	Issued for Information	LS	AA	TG
Rev	Status	Rev. Date	Purpose of revision	Drawn	Chck'd	Apprv'd

1. All dimensions are in metres unless stated otherwise.
2. These Land Plans should be read in conjunction with other plans and documents in the Development Consent Order application (TR020032/APP/3.1), in particular the Book of Reference (TR020032/APP/4.2).
3. All easements, servitudes and private rights in land are proposed to be extinguished on land shown coloured pink on these land plans. All easements, servitudes and private rights in land are proposed to be extinguished, so far as their continued exercise would be inconsistent with the exercise of the rights or restrictions proposed to be acquired by the undertaker on land shown coloured blue on these land plans.
4. All easements, servitudes and private rights are proposed to be suspended while the undertaker is in temporary possession of the land shown coloured green on these land plans.
5. The number labels relate to plot numbers. Please refer to the Book of Reference for more information about these plots, including the approximate area of each plot. Plot numbers include a reference to the relevant sheet of the Land Plans. In this numbering convention, a plot number comprises the sheet number followed by the actual plot number, e.g. Plot 01-24, where '01' is the sheet number.

- Legend**
- Order Limits
 - Local Authority Boundary
 - Permanent Acquisition of Land - The Secretary of State for Transport
 - Temporary Possession of Land - The Secretary of State for Transport
 - Temporary Possession of Land and Permanent Acquisition of Rights - The Secretary of State for Transport
 - Permanent Acquisition of Land - The Secretary of State for Transport and The Secretary of State for Environment Food and Rural Affairs
 - Temporary Possession of Land - The Secretary of State for Transport and The Secretary of State for Environment Food and Rural Affairs
 - Temporary Possession of Land and Permanent Acquisition of Rights - The Secretary of State for Transport and The Secretary of State for Environment Food and Rural Affairs

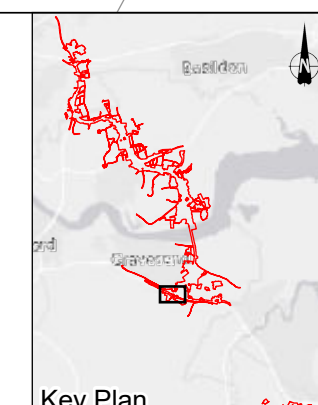

Client: national highways

Project: LOWER THAMES CROSSING

Status	DCO Application	Original Size	A1	Revision	P01
Application Document Number	TR010032/APP/2.3	Scale	1:2,500		
Drawing Title	CROWN LAND PLANS REGULATION 5(2)(n) SHEET 6 OF 49				
Drawing Number	HE450039-CJV-BOP-ZZZ_BD000000_-DR-BL-20006				

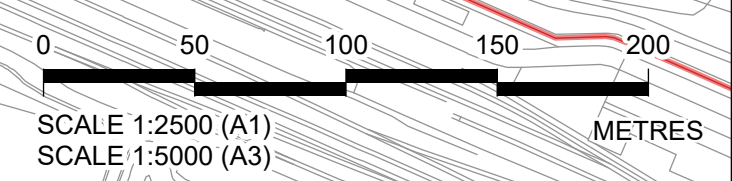
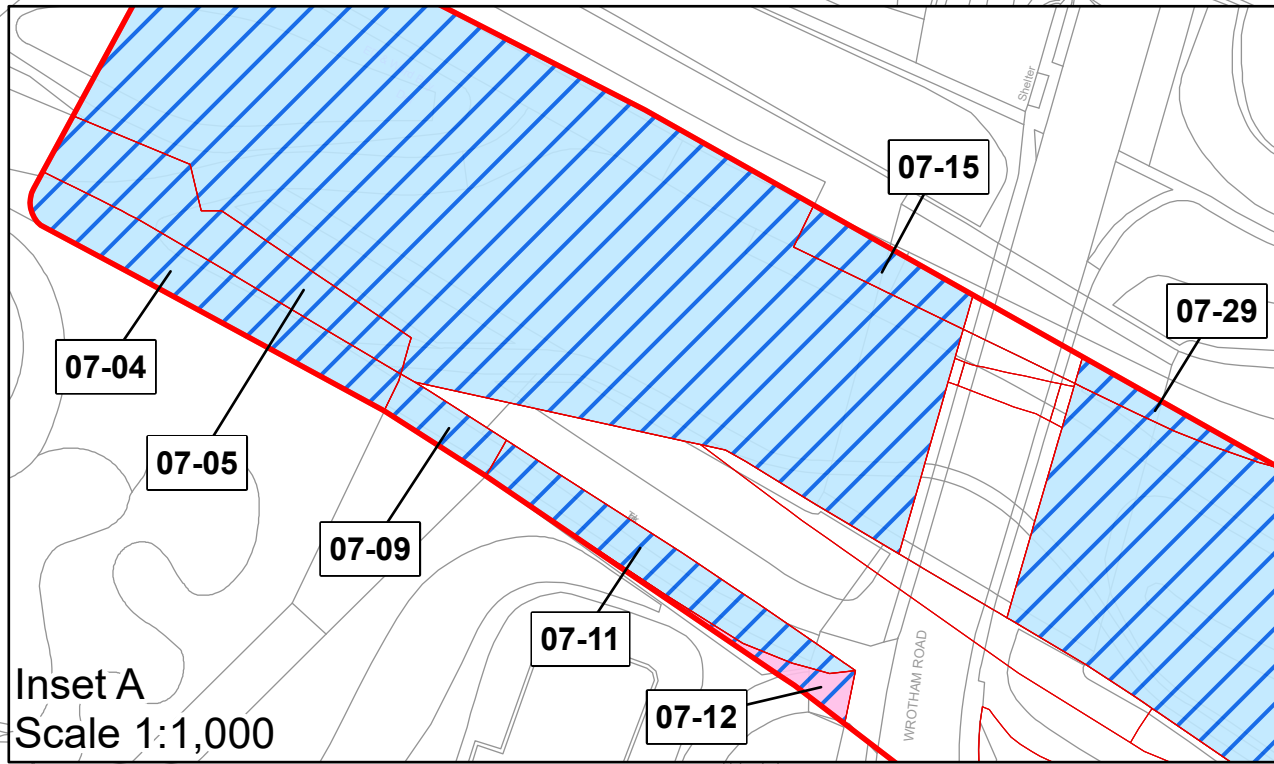
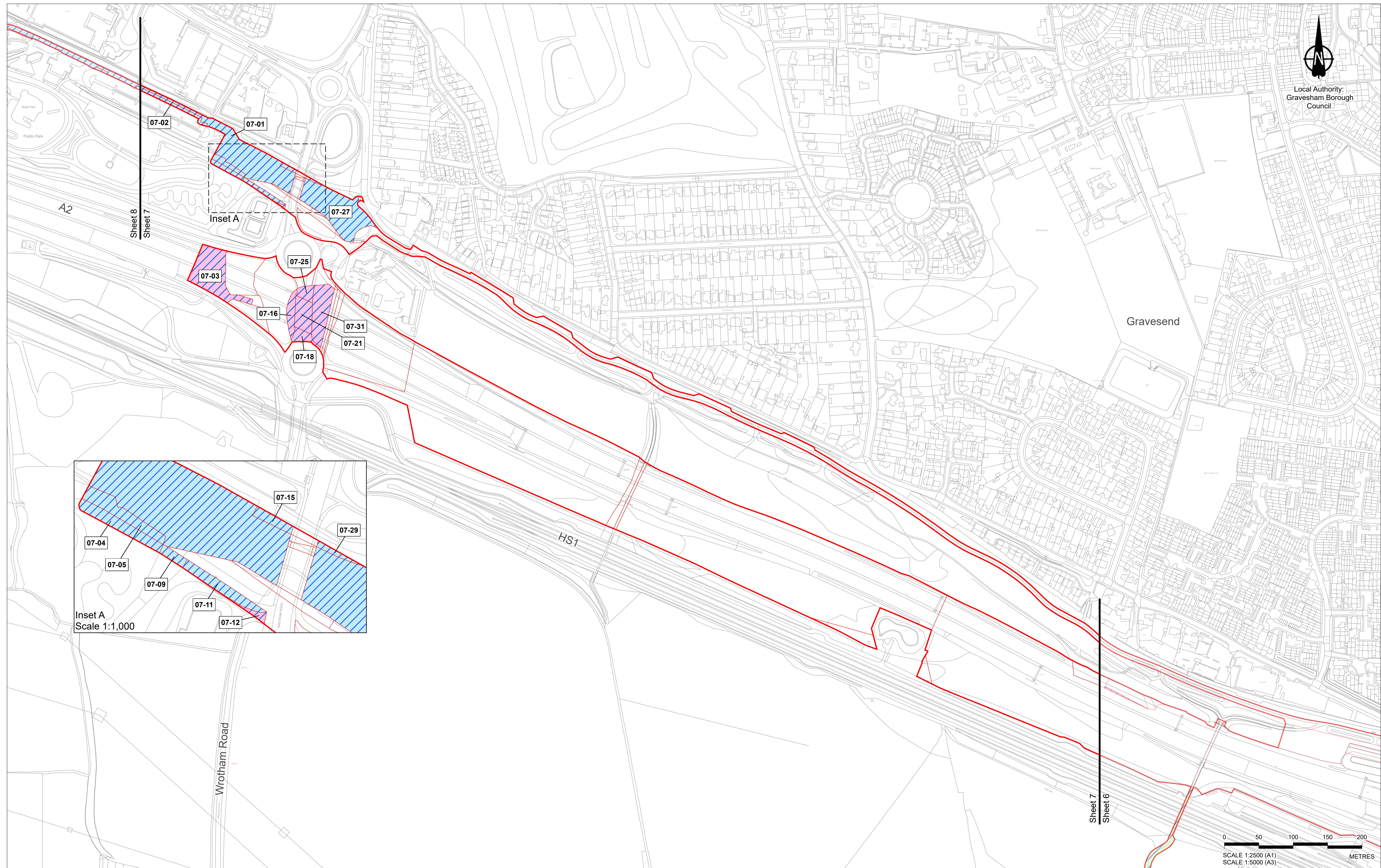

Crown copyright material is reproduced with the permission of Land Registry under delegated authority from the Controller of HMSO. This material was last updated in July 2022 and may not be copied, distributed, sold or published without the formal permission of Land Registry. Contains Ordnance Survey data. © Crown copyright and database rights 2022. Ordnance Survey 100030549

P01	S1	24/08/2022	Issued for Information	LS	AA	TG
Rev	Status	Rev. Date	Purpose of revision	Drawn	Chck'd	Apprv'd

1. All dimensions are in metres unless stated otherwise.
2. These Land Plans should be read in conjunction with other plans and documents in the Development Consent Order application (TR020032/APP/3.1), in particular the Book of Reference (TR020032/APP/4.2).
3. All easements, servitudes and private rights in land are proposed to be extinguished on land shown coloured pink on these land plans. All easements, servitudes and private rights in land are proposed to be extinguished, so far as their continued exercise would be inconsistent with the exercise of the rights or restrictions proposed to be acquired by the undertaker on land shown coloured blue on these land plans.
4. All easements, servitudes and private rights are proposed to be suspended while the undertaker is in temporary possession of the land shown coloured green on these land plans.
5. The number labels relate to plot numbers. Please refer to the Book of Reference for more information about these plots, including the approximate area of each plot. Plot numbers include a reference to the relevant sheet of the Land Plans. In this numbering convention, a plot number comprises the sheet number followed by the actual plot number, e.g: Plot 01-24, where '01' is the sheet number.

- Legend**
- Order Limits
 - Local Authority Boundary
 - Permanent Acquisition of Land - The Secretary of State for Transport
 - Temporary Possession of Land and Permanent Acquisition of Rights - The Secretary of State for Transport

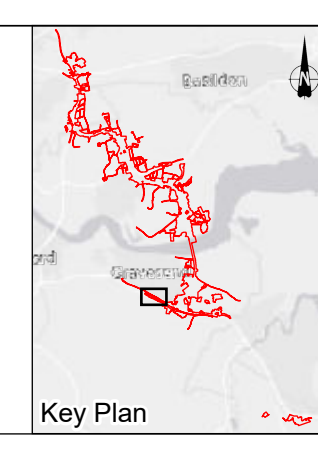

Client
national highways

Project
LOWER THAMES CROSSING

Status	DCO Application	Original Size	A1	Revision	P01
Application Document Number	TR010032/APP/2.3	Scale	1:2,500		
Drawing Title	CROWN LAND PLANS REGULATION 5(2)(n) SHEET 7 OF 49				
Drawing Number	HE450039-CJV-BOP-ZZZ_BD000000_-DR-BL-20007				

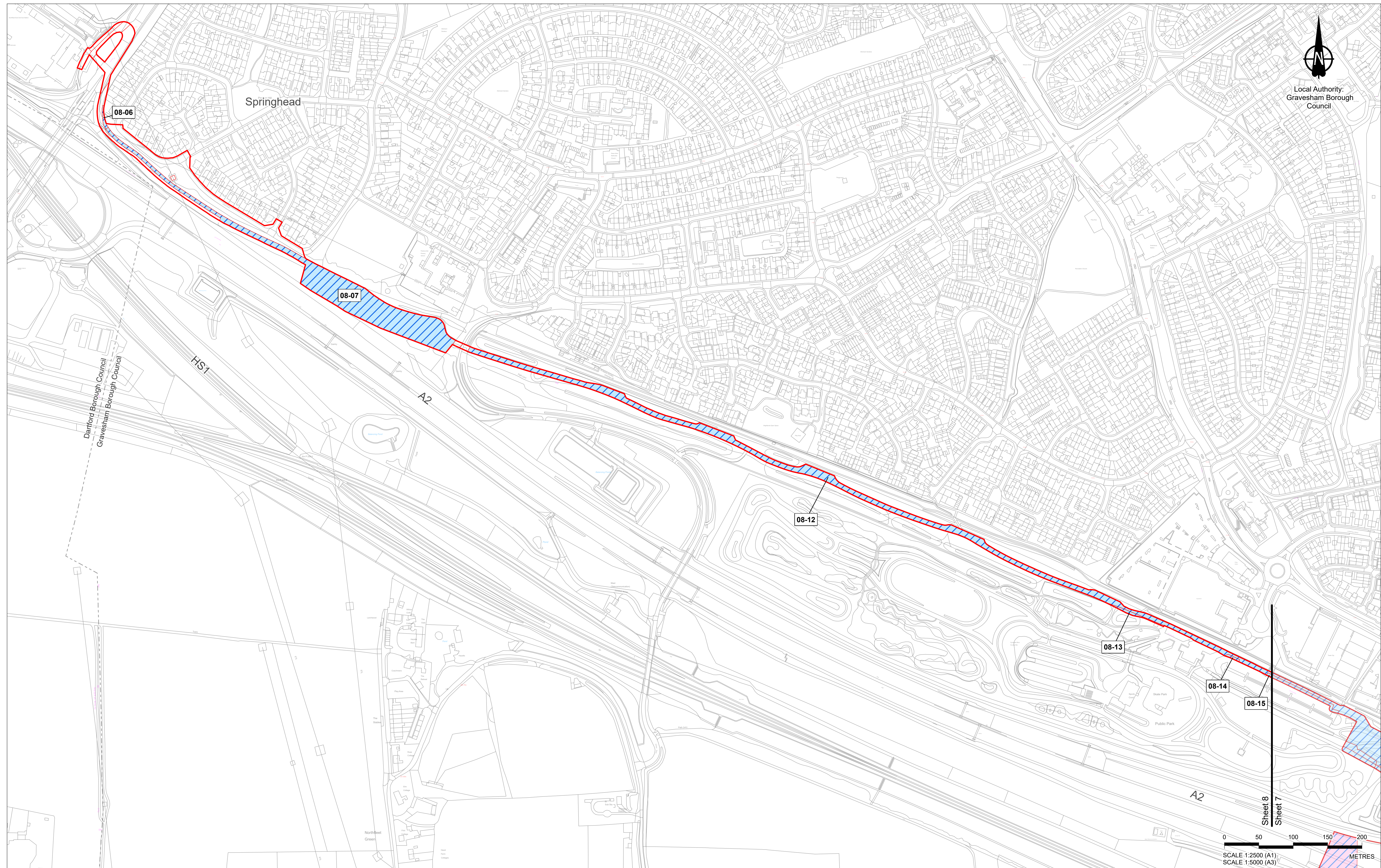

Crown copyright material is reproduced with the permission of Land Registry under delegated authority from the Controller of HMSO. This material was last updated in July 2022 and may not be copied, distributed, sold or published without the formal permission of Land Registry. Contains Ordnance Survey data. © Crown copyright and database rights 2022. Ordnance Survey 100030649

P01	S1	24/08/2022	Issued for Information	LS	AA	TG
Rev	Status	Rev. Date	Purpose of revision	Drawn	Check'd	Apprv'd

1. All dimensions are in metres unless stated otherwise.
2. These Land Plans should be read in conjunction with other plans and documents in the Development Consent Order application (TR020032/APP/3.1), in particular the Book of Reference (TR020032/APP/4.2).
3. All easements, servitudes and private rights in land are proposed to be extinguished on land shown coloured pink on these land plans. All easements, servitudes and private rights in land are proposed to be extinguished, so far as their continued exercise would be inconsistent with the exercise of the rights or restrictions proposed to be acquired by the undertaker on land shown coloured blue on these land plans.
4. All easements, servitudes and private rights are proposed to be suspended while the undertaker is in temporary possession of the land shown coloured green on these land plans.
5. The number labels relate to plot numbers. Please refer to the Book of Reference for more information about these plots, including the approximate area of each plot. Plot numbers include a reference to the relevant sheet of the Land Plans. In this numbering convention, a plot number comprises the sheet number followed by the actual plot number, e.g: Plot 01-24, where '01' is the sheet number.

Legend

- Order Limits
- Local Authority Boundary
- Temporary Possession of Land and Permanent Acquisition of Rights - The Secretary of State for Transport

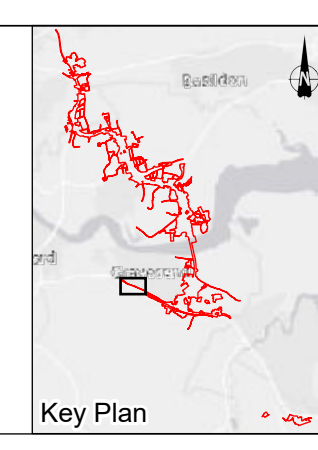

Client: national highways

Project: LOWER THAMES CROSSING

Status	DCO Application	Original Size	A1	Revision	P01
Application Document Number	TR010032/APP/2.3	Scale	1:2,500		
Drawing Title	CROWN LAND PLANS REGULATION 5(2)(n) SHEET 8 OF 49				
Drawing Number	HE450039-CJV-BOP-ZZZ_BD000000_-DR-BL-20008				

**NO DESIGN INFORMATION ON THIS SHEET
FOR CROWN LAND PLANS**

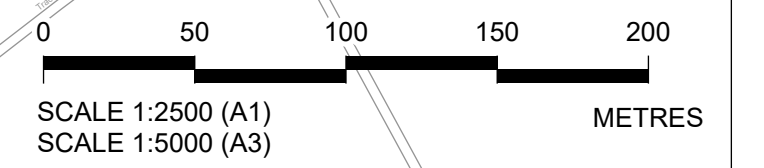

Crown copyright material is reproduced with the permission of Land Registry under delegated authority from the Controller of HMSO. This material was last updated in July 2022 and may not be copied, distributed, sold or published without the formal permission of Land Registry. Contains Ordnance Survey data. © Crown copyright and database rights 2022. Ordnance Survey 100030649

1. All dimensions are in metres unless stated otherwise.
2. These Land Plans should be read in conjunction with other plans and documents in the Development Consent Order application (TR020032/APP/3.1), in particular the Book of Reference (TR020032/APP/4.2).
3. All easements, servitudes and private rights in land are proposed to be extinguished on land shown coloured pink on these land plans. All easements, servitudes and private rights in land are proposed to be extinguished, so far as their continued exercise would be inconsistent with the exercise of the rights or restrictions proposed to be acquired by the undertaker on land shown coloured blue on these land plans.
4. All easements, servitudes and private rights are proposed to be suspended while the undertaker is in temporary possession of the land shown coloured green on these land plans.
5. The number labels relate to plot numbers. Please refer to the Book of Reference for more information about these plots, including the approximate area of each plot. Plot numbers include a reference to the relevant sheet of the Land Plans. In this numbering convention, a plot number comprises the sheet number followed by the actual plot number, e.g: Plot 01-24, where '01' is the sheet number.

Legend
 Order Limits
 Local Authority Boundary

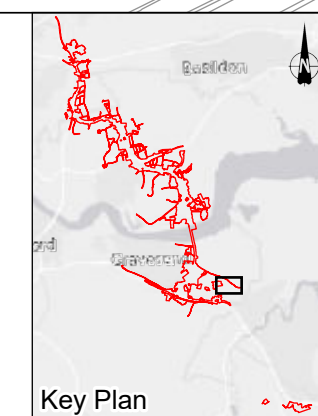

Client
 Project
LOWER THAMES CROSSING

Status	DCO Application	Original Size	A1	Revision	P01
Application Document Number	TR010032/APP/2.3	Scale	1:2,500		
Drawing Title	CROWN LAND PLANS REGULATION 5(2)(n) SHEET 9 OF 49				
Drawing Number	HE450039-CJV-BOP-ZZZ_BD000000_-DR-BL-20009				

Rev	Status	Rev. Date	Purpose of revision	Drawn	Chck'd	Apprv'd
P01	S1	24/08/2022	Issued for Information	LS	AA	TG

Sheet 12
Sheet 10



**NO DESIGN INFORMATION ON THIS SHEET
FOR CROWN LAND PLANS**

Sheet 11
Sheet 10

Sheet 10
Sheet 4

Sheet 10
Sheet 9

Sheet 10
Sheet 3

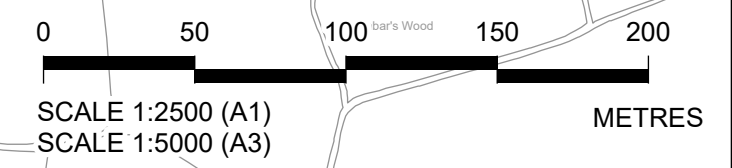

Crown copyright material is reproduced with the permission of Land Registry under delegated authority from the Controller of HMSO. This material was last updated in July 2022 and may not be copied, distributed, sold or published without the formal permission of Land Registry. Contains Ordnance Survey data. © Crown copyright and database rights 2022. Ordnance Survey 100030649

1. All dimensions are in metres unless stated otherwise.
2. These Land Plans should be read in conjunction with other plans and documents in the Development Consent Order application (TR020032/APP/3.1), in particular the Book of Reference (TR020032/APP/4.2).
3. All easements, servitudes and private rights in land are proposed to be extinguished on land shown coloured pink on these land plans. All easements, servitudes and private rights in land are proposed to be extinguished, so far as their continued exercise would be inconsistent with the exercise of the rights or restrictions proposed to be acquired by the undertaker on land shown coloured blue on these land plans.
4. All easements, servitudes and private rights are proposed to be suspended while the undertaker is in temporary possession of the land shown coloured green on these land plans.
5. The number labels relate to plot numbers. Please refer to the Book of Reference for more information about these plots, including the approximate area of each plot. Plot numbers include a reference to the relevant sheet of the Land Plans. In this numbering convention, a plot number comprises the sheet number followed by the actual plot number, e.g: Plot 01-24, where '01' is the sheet number.

Legend
 Order Limits
 Local Authority Boundary

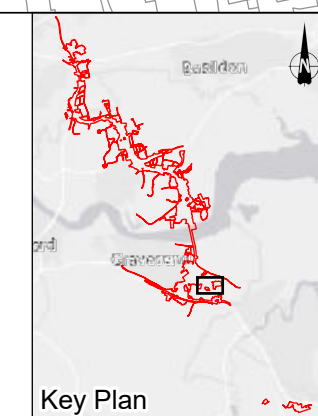

Client

 Project
LOWER THAMES CROSSING

Status	DCO Application	Original Size	A1	Revision	P01
Application Document Number	TR010032/APP/2.3	Scale	1:2,500		
Drawing Title	CROWN LAND PLANS REGULATION 5(2)(n) SHEET 10 OF 49				
Drawing Number	HE450039-CJV-BOP-ZZZ_BD000000_-DR-BL-20010				

P01	S1	24/08/2022	Issued for Information	LS	AA	TG
Rev	Status	Rev. Date	Purpose of revision	Drawn	Chck'd	Apprv'd



Local Authority:
Gravesham Borough
Council

Sheet 13
Sheet 11

Southern Valley
Golf Course

Riverview
Park

Imperial Drive

Thong Lane

Astra Drive

**NO DESIGN INFORMATION ON THIS SHEET
FOR CROWN LAND PLANS**

Shorne Woods Country Park
and
Shorne Woods SSSI

Sheet 11
Sheet 6

Thong

Sheet 11
Sheet 4

Claylane
Wood

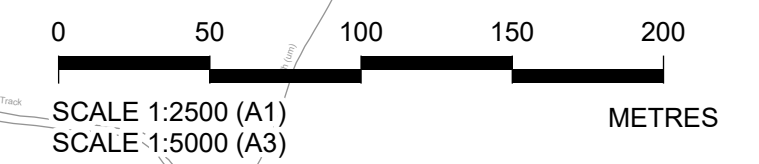

Sheet 11
Sheet 10

Crown copyright material is reproduced with the permission of Land Registry under delegated authority from the Controller of HMSO. This material was last updated in July 2022 and may not be copied, distributed, sold or published without the formal permission of Land Registry. Contains Ordnance Survey data. © Crown copyright and database rights 2022. Ordnance Survey 100030649

1. All dimensions are in metres unless stated otherwise.
2. These Land Plans should be read in conjunction with other plans and documents in the Development Consent Order application (TR020032/APP/3.1), in particular the Book of Reference (TR020032/APP/4.2).
3. All easements, servitudes and private rights in land are proposed to be extinguished on land shown coloured pink on these land plans. All easements, servitudes and private rights in land are proposed to be extinguished, so far as their continued exercise would be inconsistent with the exercise of the rights or restrictions proposed to be acquired by the undertaker on land shown coloured blue on these land plans.
4. All easements, servitudes and private rights are proposed to be suspended while the undertaker is in temporary possession of the land shown coloured green on these land plans.
5. The number labels relate to plot numbers. Please refer to the Book of Reference for more information about these plots, including the approximate area of each plot. Plot numbers include a reference to the relevant sheet of the Land Plans. In this numbering convention, a plot number comprises the sheet number followed by the actual plot number, e.g: Plot 01-24, where '01' is the sheet number.

Legend
 Order Limits
 Local Authority Boundary

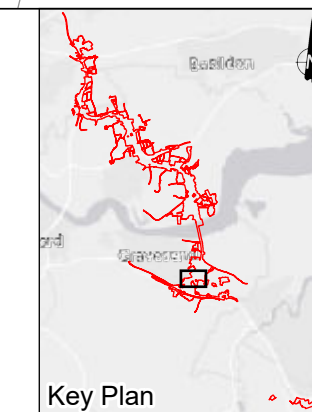

Client
Project



LOWER THAMES CROSSING

Status	DCO Application	Original Size	A1	Revision	P01
Application Document Number	TR010032/APP/2.3	Scale	1:2,500		
Drawing Title	CROWN LAND PLANS REGULATION 5(2)(n) SHEET 11 OF 49				
Drawing Number	HE450039-CJV-BOP-ZZZ_BD000000_-DR-BL-20011				

P01	S1	24/08/2022	Issued for Information	LS	AA	TG
Rev	Status	Rev. Date	Purpose of revision	Drawn	Chk'd	Apprv'd

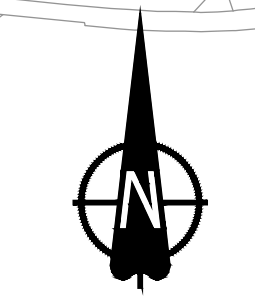

Local Authority:
Gravesham Borough Council

**NO DESIGN INFORMATION ON THIS SHEET
FOR CROWN LAND PLANS**

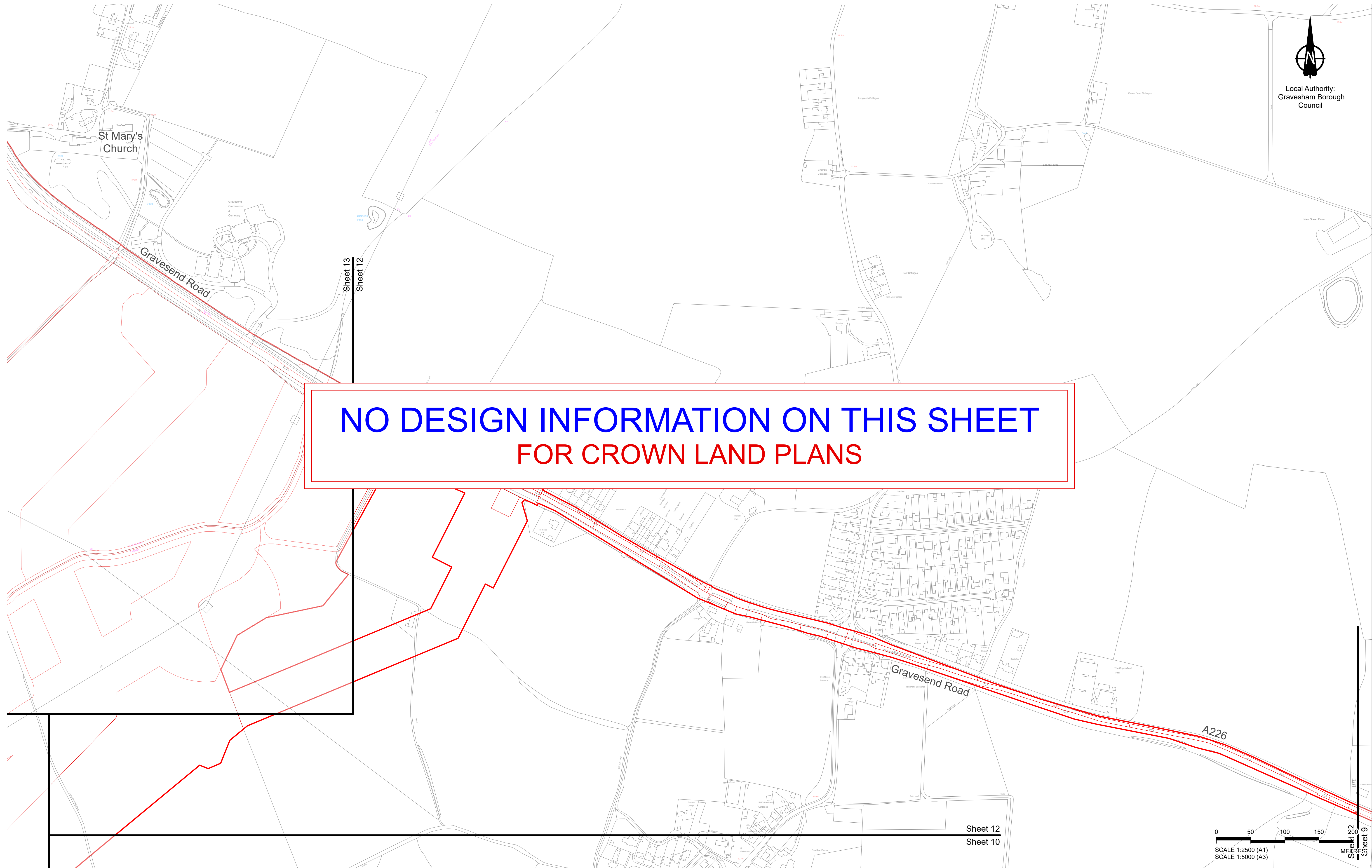

P01	S1	24/08/2022	Issued for Information	LS	AA	TG
Rev	Status	Rev. Date	Purpose of revision	Drawn	Chck'd	Apprv'd

1. All dimensions are in metres unless stated otherwise.
 2. These Land Plans should be read in conjunction with other plans and documents in the Development Consent Order application (TR020032/APP/3.1), in particular the Book of Reference (TR020032/APP/4.2).
 3. All easements, servitudes and private rights in land are proposed to be extinguished on land shown coloured pink on these land plans. All easements, servitudes and private rights in land are proposed to be extinguished, so far as their continued exercise would be inconsistent with the exercise of the rights or restrictions proposed to be acquired by the undertaker on land shown coloured blue on these land plans.
 4. All easements, servitudes and private rights are proposed to be suspended while the undertaker is in temporary possession of the land shown coloured green on these land plans.
 5. The number labels relate to plot numbers. Please refer to the Book of Reference for more information about these plots, including the approximate area of each plot. Plot numbers include a reference to the relevant sheet of the Land Plans. In this numbering convention, a plot number comprises the sheet number followed by the actual plot number, e.g: Plot 01-24, where '01' is the sheet number.

Legend
 Order Limits
 Local Authority Boundary

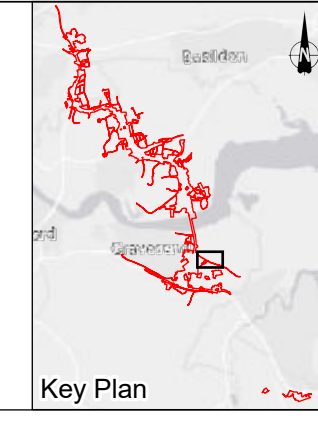

Client

 Project
LOWER THAMES CROSSING

Status	DCO Application	Original Size	A1	Revision	P01
Application Document Number	TR010032/APP/2.3	Scale	1:2,500		
Drawing Title	CROWN LAND PLANS REGULATION 5(2)(n) SHEET 12 OF 49				
Drawing Number	HE450039-CJV-BOP-ZZZ_BD000000_-DR-BL-20012				

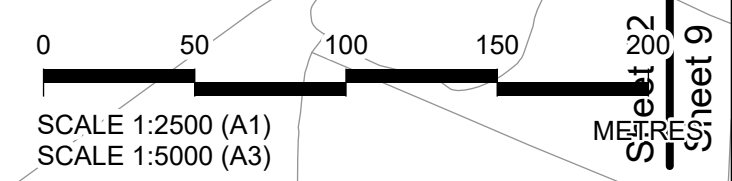

Sheet 12
Sheet 10

Crown copyright material is reproduced with the permission of Land Registry under delegated authority from the Controller of HMSO. This material was last updated in July 2022 and may not be copied, distributed, sold or published without the formal permission of Land Registry. Contains Ordnance Survey data. © Crown copyright and database rights 2022. Ordnance Survey 100030549

**NO DESIGN INFORMATION ON THIS SHEET
FOR CROWN LAND PLANS**

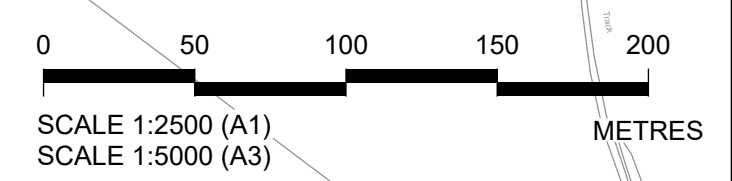

P01	S1	24/08/2022	Issued for Information	LS	AA	TG
Rev	Status	Rev. Date	Purpose of revision	Drawn	Check'd	Apprv'd

1. All dimensions are in metres unless stated otherwise.
 2. These Land Plans should be read in conjunction with other plans and documents in the Development Consent Order application (TR020032/APP/3.1), in particular the Book of Reference (TR020032/APP/4.2).
 3. All easements, servitudes and private rights in land are proposed to be extinguished on land shown coloured pink on these land plans. All easements, servitudes and private rights in land are proposed to be extinguished, so far as their continued exercise would be inconsistent with the exercise of the rights or restrictions proposed to be acquired by the undertaker on land shown coloured blue on these land plans.
 4. All easements, servitudes and private rights are proposed to be suspended while the undertaker is in temporary possession of the land shown coloured green on these land plans.
 5. The number labels relate to plot numbers. Please refer to the Book of Reference for more information about these plots, including the approximate area of each plot. Plot numbers include a reference to the relevant sheet of the Land Plans. In this numbering convention, a plot number comprises the sheet number followed by the actual plot number, e.g: Plot 01-24, where '01' is the sheet number.

Legend
 Order Limits
 Local Authority Boundary

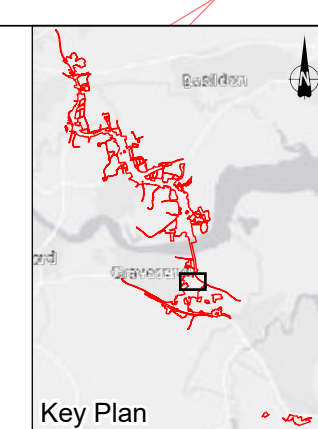

Client

 Project
LOWER THAMES CROSSING

Status	DCO Application	Original Size	A1	Revision	P01
Application Document Number	TR010032/APP/2.3	Scale	1:2,500		
Drawing Title	CROWN LAND PLANS REGULATION 5(2)(n) SHEET 13 OF 49				
Drawing Number	HE450039-CJV-BOP-ZZZ_BD000000_-DR-BL-20013				

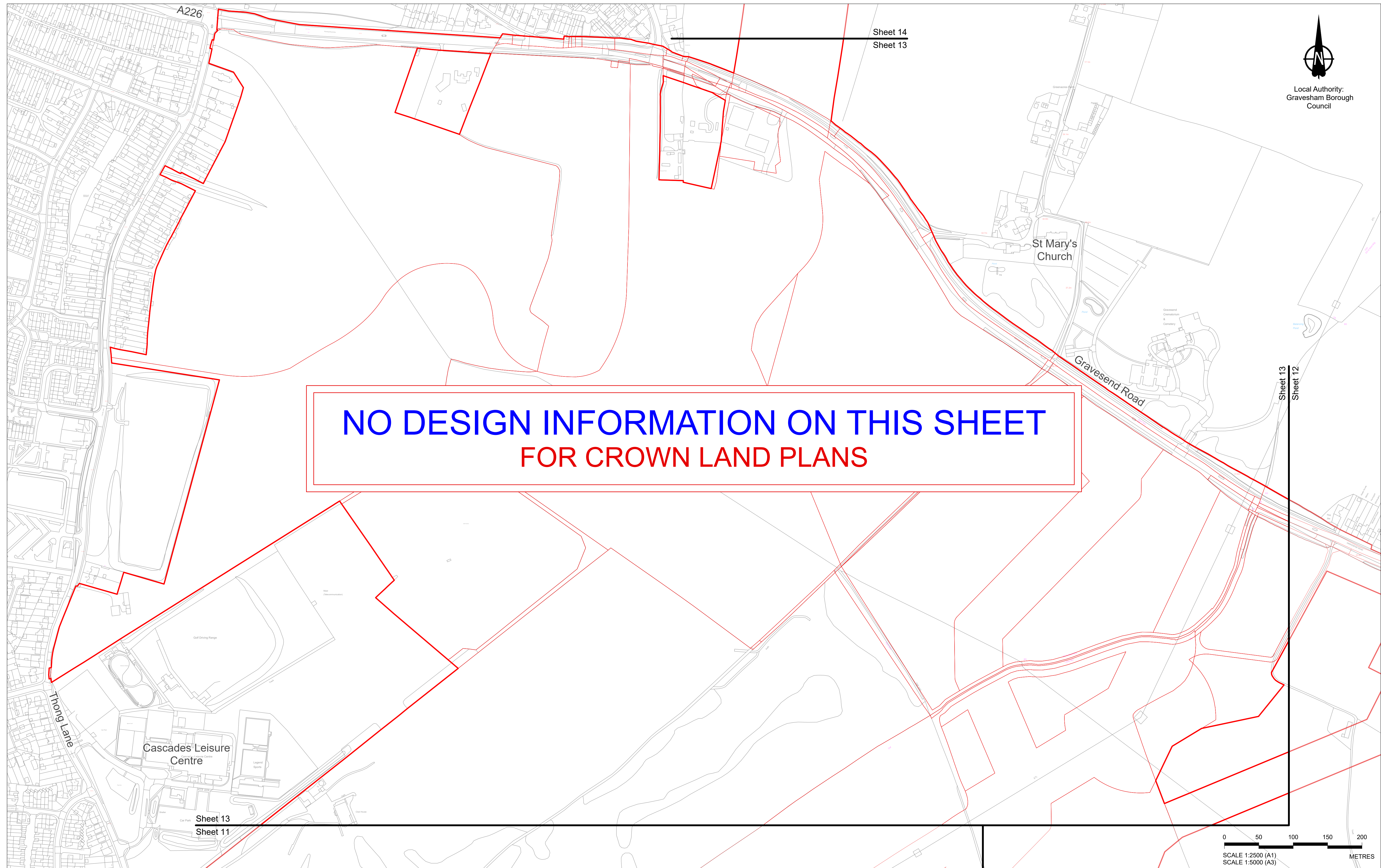



Local Authority:
Gravesham Borough
Council

Sheet 15

Sheet 14

North Kent Railway
Thames and Medway Canal

Filborough Marshes

Thames Estuary and Marshes
SPA, SSSI and Ramsar Site

**NO DESIGN INFORMATION ON THIS SHEET
FOR CROWN LAND PLANS**

Lower Higham Road

Chalk

A226

Sheet 14

Sheet 13

0 50 100 150 200
SCALE 1:2500 (A1)
SCALE 1:5000 (A3) METRES

Crown copyright material is reproduced with the permission of Land Registry under delegated authority from the Controller of HMSO. This material was last updated in July 2022 and may not be copied, distributed, sold or published without the formal permission of Land Registry. Contains Ordnance Survey data. © Crown copyright and database rights 2022. Ordnance Survey 100030549

1. All dimensions are in metres unless stated otherwise.
2. These Land Plans should be read in conjunction with other plans and documents in the Development Consent Order application (TR020032/APP/3.1), in particular the Book of Reference (TR020032/APP/4.2).
3. All easements, servitudes and private rights in land are proposed to be extinguished on land shown coloured pink on these land plans. All easements, servitudes and private rights in land are proposed to be extinguished, so far as their continued exercise would be inconsistent with the exercise of the rights or restrictions proposed to be acquired by the undertaker on land shown coloured blue on these land plans.
4. All easements, servitudes and private rights are proposed to be suspended while the undertaker is in temporary possession of the land shown coloured green on these land plans.
5. The number labels relate to plot numbers. Please refer to the Book of Reference for more information about these plots, including the approximate area of each plot. Plot numbers include a reference to the relevant sheet of the Land Plans. In this numbering convention, a plot number comprises the sheet number followed by the actual plot number, e.g. Plot 01-24, where '01' is the sheet number.

Legend
Order Limits
Local Authority Boundary

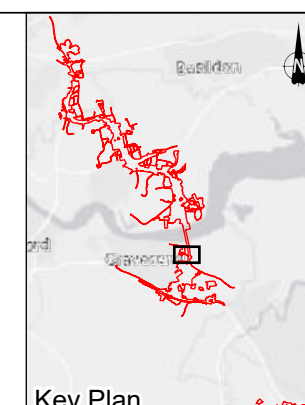

Client



Project

LOWER THAMES CROSSING

Status	DCO Application	Original Size	A1	Revision	P01
Application Document Number	TR010032/APP/2.3	Scale	1:2,500		
Drawing Title	CROWN LAND PLANS REGULATION 5(2)(n) SHEET 14 OF 49				
Drawing Number	HE450039-CJV-BOP-ZZZ_BD000000_-DR-BL-20014				

Rev	Status	Rev. Date	Purpose of revision	Drawn	Check'd	Apprv'd
P01	S1	24/08/2022	Issued for Information	LS	AA	TG

Thurrock Council
Gravesham Borough Council

River
Thames

**NO DESIGN INFORMATION ON THIS SHEET
FOR CROWN LAND PLANS**



North Kent Railway
Thames and Medway Canal

Sheet 15
Sheet 14

0 50 100 150 200
SCALE 1:2500 (A1)
SCALE 1:5000 (A3)
METRES

Crown copyright material is reproduced with the permission of Land Registry under delegated authority from the Controller of HMSO. This material was last updated in July 2022 and may not be copied, distributed, sold or published without the formal permission of Land Registry. Contains Ordnance Survey data. © Crown copyright and database rights 2022. Ordnance Survey 100030549

1. All dimensions are in metres unless stated otherwise.
2. These Land Plans should be read in conjunction with other plans and documents in the Development Consent Order application (TR020032/APP/3.1), in particular the Book of Reference (TR020032/APP/4.2).
3. All easements, servitudes and private rights in land are proposed to be extinguished on land shown coloured pink on these land plans. All easements, servitudes and private rights in land are proposed to be extinguished, so far as their continued exercise would be inconsistent with the exercise of the rights or restrictions proposed to be acquired by the undertaker on land shown coloured blue on these land plans.
4. All easements, servitudes and private rights are proposed to be suspended while the undertaker is in temporary possession of the land shown coloured green on these land plans.
5. The number labels relate to plot numbers. Please refer to the Book of Reference for more information about these plots, including the approximate area of each plot. Plot numbers include a reference to the relevant sheet of the Land Plans. In this numbering convention, a plot number comprises the sheet number followed by the actual plot number, e.g: Plot 01-24, where '01' is the sheet number.

Legend
 Order Limits
 Local Authority Boundary

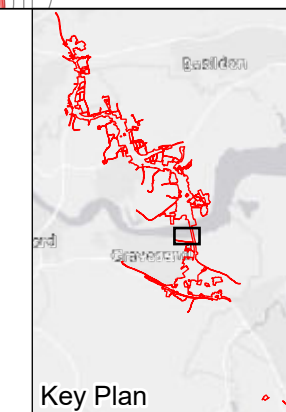

Client
Project



LOWER THAMES CROSSING

Status	DCO Application	Original Size	A1	Revision	P01
Application Document Number	TR010032/APP/2.3	Scale	1:2,500		
Drawing Title	CROWN LAND PLANS REGULATION 5(2)(n) SHEET 15 OF 49				
Drawing Number	HE450039-CJV-BOP-ZZZ_BD000000_-DR-BL-20015				

P01	S1	24/08/2022	Issued for Information	LS	AA	TG
Rev	Status	Rev. Date	Purpose of revision	Drawn	Chck'd	Apprv'd

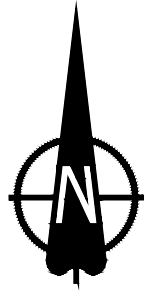

Sheet 21
Sheet 16

**NO DESIGN INFORMATION ON THIS SHEET
FOR CROWN LAND PLANS**

River
Thames

Thurrock Council
Gravesham Borough Council

Sheet 16
Sheet 15

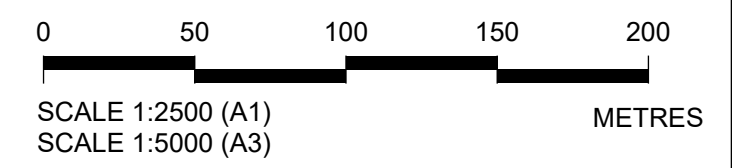

Crown copyright material is reproduced with the permission of Land Registry under delegated authority from the Controller of HMSO. This material was last updated in July 2022 and may not be copied, distributed, sold or published without the formal permission of Land Registry. Contains Ordnance Survey data. © Crown copyright and database rights 2022. Ordnance Survey 100030649

1. All dimensions are in metres unless stated otherwise.
2. These Land Plans should be read in conjunction with other plans and documents in the Development Consent Order application (TR020032/APP/3.1), in particular the Book of Reference (TR020032/APP/4.2).
3. All easements, servitudes and private rights in land are proposed to be extinguished on land shown coloured pink on these land plans. All easements, servitudes and private rights in land are proposed to be extinguished, so far as their continued exercise would be inconsistent with the exercise of the rights or restrictions proposed to be acquired by the undertaker on land shown coloured blue on these land plans.
4. All easements, servitudes and private rights are proposed to be suspended while the undertaker is in temporary possession of the land shown coloured green on these land plans.
5. The number labels relate to plot numbers. Please refer to the Book of Reference for more information about these plots, including the approximate area of each plot. Plot numbers include a reference to the relevant sheet of the Land Plans. In this numbering convention, a plot number comprises the sheet number followed by the actual plot number, e.g: Plot 01-24, where '01' is the sheet number.

Legend
 Order Limits
 Local Authority Boundary

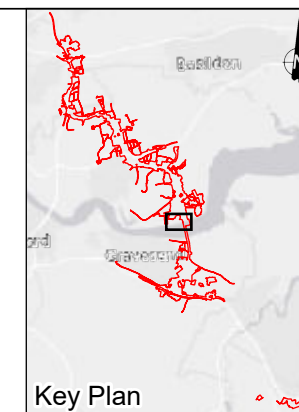

Client
national highways

Project
LOWER THAMES CROSSING

Status	DCO Application	Original Size	A1	Revision	P01
Application Document Number	TR010032/APP/2.3	Scale	1:2,500		
Drawing Title	CROWN LAND PLANS REGULATION 5(2)(n) SHEET 16 OF 49				
Drawing Number	HE450039-CJV-BOP-ZZZ_BD000000_-DR-BL-20016				

P01	S1	24/08/2022	Issued for Information	LS	AA	TG
Rev	Status	Rev. Date	Purpose of revision	Drawn	Chck'd	Apprv'd

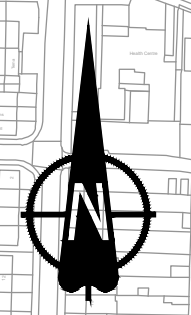
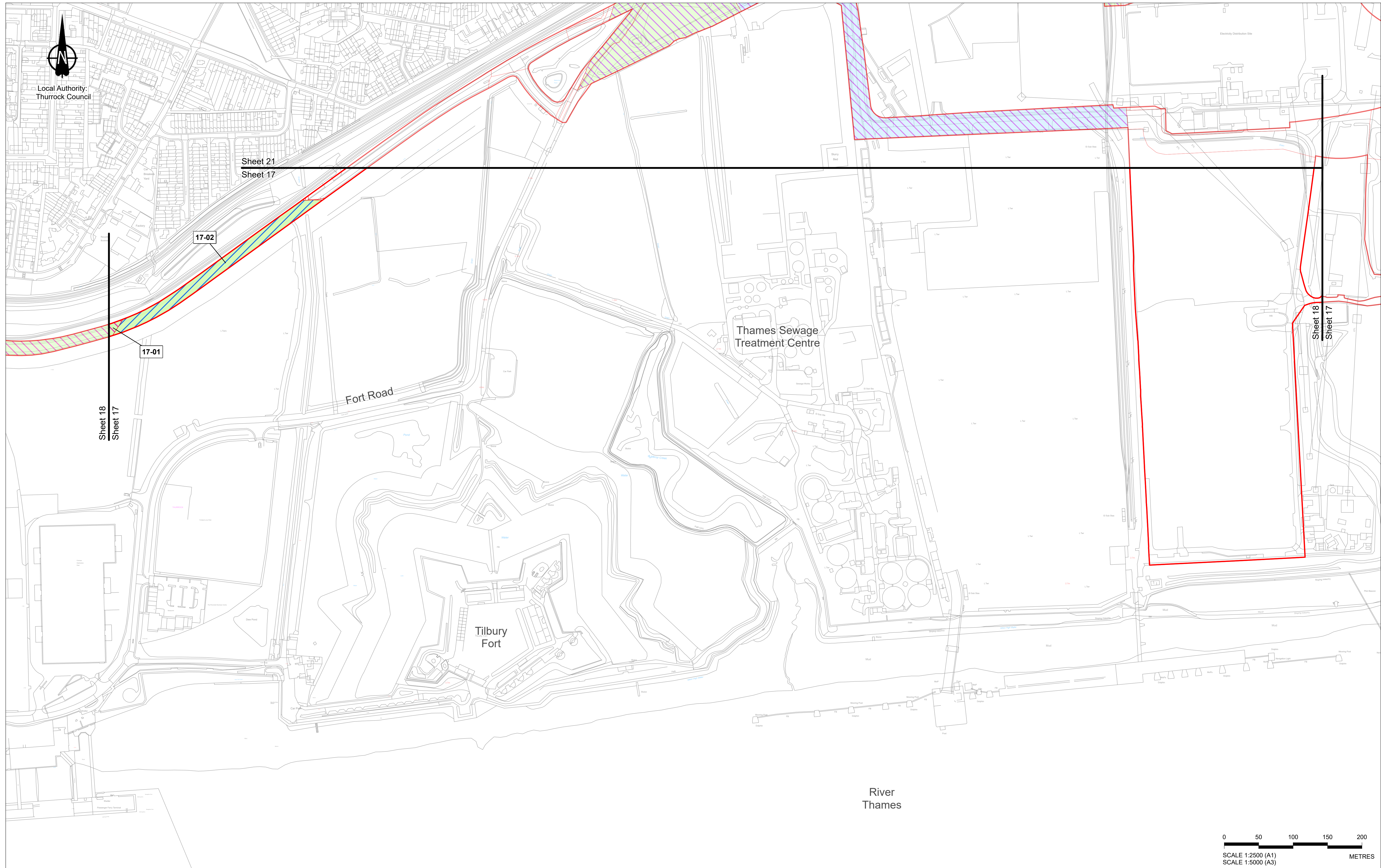

Local Authority:
Thurrock Council

Sheet 21
Sheet 17

17-02

17-01

Fort Road

Thames Sewage
Treatment Centre

Tilbury
Fort

River
Thames

Sheet 18
Sheet 17

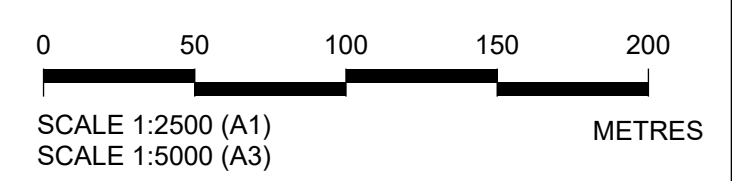

Crown copyright material is reproduced with the permission of Land Registry under delegated authority from the Controller of HMSO. This material was last updated in July 2022 and may not be copied, distributed, sold or published without the formal permission of Land Registry. Contains Ordnance Survey data. © Crown copyright and database rights 2022. Ordnance Survey 100030649

1. All dimensions are in metres unless stated otherwise.
2. These Land Plans should be read in conjunction with other plans and documents in the Development Consent Order application (TR020032/APP/3.1), in particular the Book of Reference (TR020032/APP/4.2).
3. All easements, servitudes and private rights in land are proposed to be extinguished on land shown coloured pink on these land plans. All easements, servitudes and private rights in land are proposed to be extinguished, so far as their continued exercise would be inconsistent with the exercise of the rights or restrictions proposed to be acquired by the undertaker on land shown coloured blue on these land plans.
4. All easements, servitudes and private rights are proposed to be suspended while the undertaker is in temporary possession of the land shown coloured green on these land plans.
5. The number labels relate to plot numbers. Please refer to the Book of Reference for more information about these plots, including the approximate area of each plot. Plot numbers include a reference to the relevant sheet of the Land Plans. In this numbering convention, a plot number comprises the sheet number followed by the actual plot number, e.g: Plot 01-24, where '01' is the sheet number.

- Legend**
- Order Limits
 - Local Authority Boundary
 - Temporary Possession of Land - The Secretary of State for Transport
 - Temporary Possession of Land - British Railways Board Limited

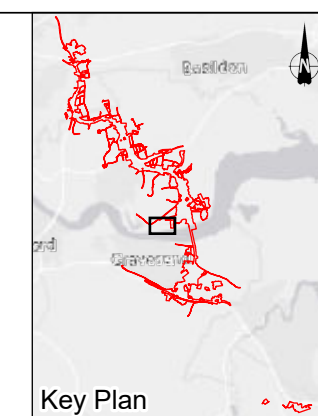

Client
national highways

Project
LOWER THAMES CROSSING

Status	DCO Application	Original Size	A1	Revision	P01
Application Document Number	TR010032/APP/2.3	Scale	1:2,500		
Drawing Title	CROWN LAND PLANS REGULATION 5(2)(n) SHEET 17 OF 49				
Drawing Number	HE450039-CJV-BOP-ZZZ_BD000000_-DR-BL-20017				

P01	S1	24/08/2022	Issued for Information	LS	AA	TG
Rev	Status	Rev. Date	Purpose of revision	Drawn	Check'd	Apprv'd

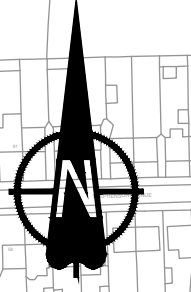
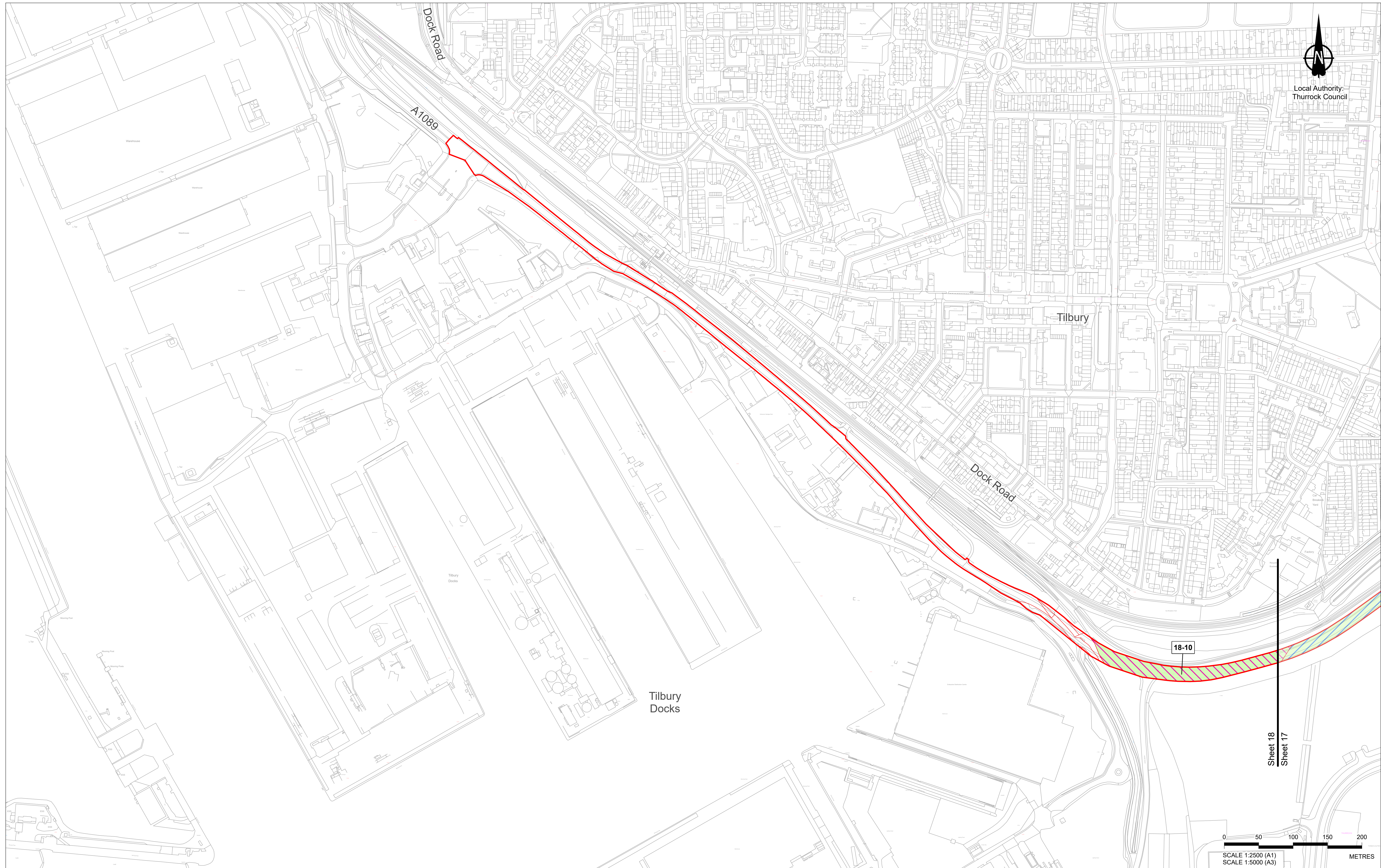

Local Authority:
Thurrock Council

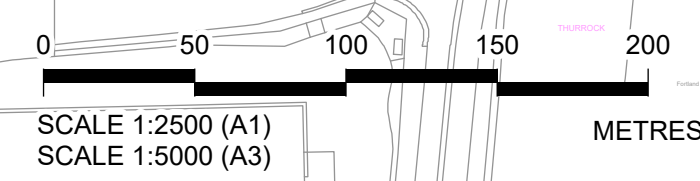

Sheet 18
Sheet 17

Crown copyright material is reproduced with the permission of Land Registry under delegated authority from the Controller of HMSO. This material was last updated in July 2022 and may not be copied, distributed, sold or published without the formal permission of Land Registry. Contains Ordnance Survey data. © Crown copyright and database rights 2022. Ordnance Survey 100030649

Rev	Status	Rev. Date	Purpose of revision	Drawn	Chck'd	Apprv'd
P01	S1	24/08/2022	Issued for Information	LS	AA	TG

1. All dimensions are in metres unless stated otherwise.
2. These Land Plans should be read in conjunction with other plans and documents in the Development Consent Order application (TR020032/APP/3.1), in particular the Book of Reference (TR020032/APP/4.2).
3. All easements, servitudes and private rights in land are proposed to be extinguished on land shown coloured pink on these land plans. All easements, servitudes and private rights in land are proposed to be extinguished, so far as their continued exercise would be inconsistent with the exercise of the rights or restrictions proposed to be acquired by the undertaker on land shown coloured blue on these land plans.
4. All easements, servitudes and private rights are proposed to be suspended while the undertaker is in temporary possession of the land shown coloured green on these land plans.
5. The number labels relate to plot numbers. Please refer to the Book of Reference for more information about these plots, including the approximate area of each plot. Plot numbers include a reference to the relevant sheet of the Land Plans. In this numbering convention, a plot number comprises the sheet number followed by the actual plot number, e.g: Plot 01-24, where '01' is the sheet number.

Legend

- Order Limits
- Local Authority Boundary
- Temporary Possession of Land - British Railways Board Limited

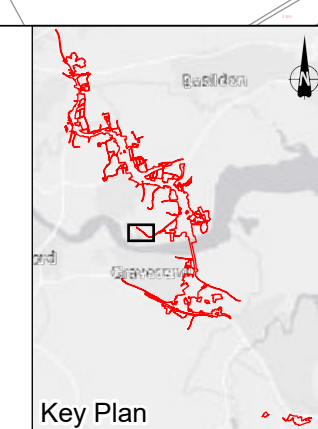

Client

Project

LOWER THAMES CROSSING

Status	DCO Application	Original Size	A1	Revision	P01
Application Document Number	TR010032/APP/2.3	Scale	1:2,501		
Drawing Title	CROWN LAND PLANS REGULATION 5(2)(n) SHEET 18 OF 49				
Drawing Number	HE450039-CJV-BOP-ZZZ_BD000000_-DR-BL-20018				

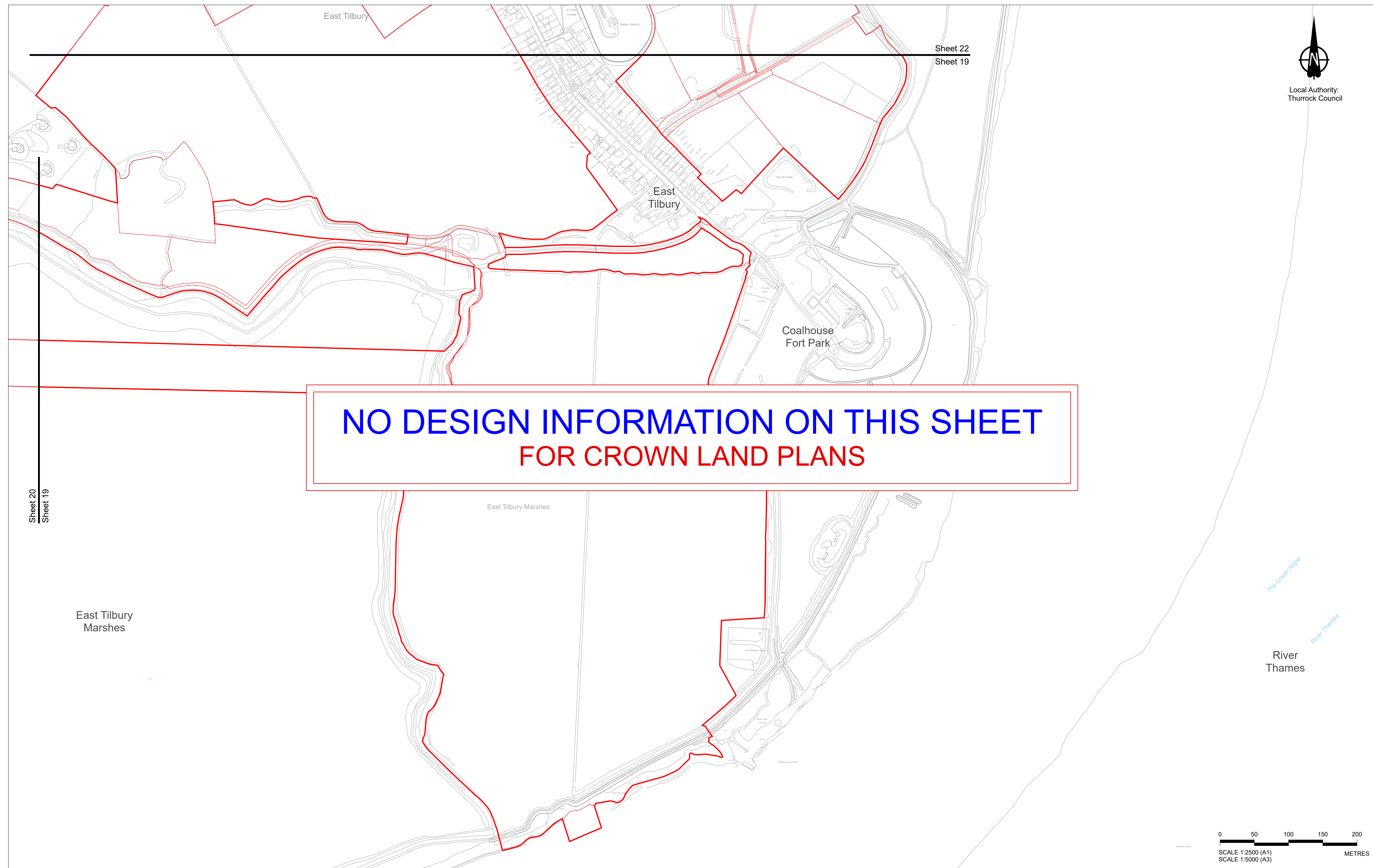

**NO DESIGN INFORMATION ON THIS SHEET
FOR CROWN LAND PLANS**

Crown copyright material is reproduced with the permission of Land Registry under delegated authority from the Controller of HMSO. This material was last updated in July 2022 and may not be copied, distributed, sold or published without the formal permission of Land Registry. Contains Ordnance Survey data. © Crown copyright and database rights 2022. Ordnance Survey 100030549

P01	S1	24/08/2022	Issued for Information	LS	AA	TG
Rev	Status	Rev. Date	Purpose of revision	Drawn	Chck'd	Apprv'd

1. All dimensions are in metres unless stated otherwise.
2. These Land Plans should be read in conjunction with other plans and documents in the Development Consent Order application (TR020032/APP/3.1), in particular the Book of Reference (TR020032/APP/4.2).
3. All easements, servitudes and private rights in land are proposed to be extinguished on land shown coloured pink on these land plans. All easements, servitudes and private rights in land are proposed to be extinguished, so far as their continued exercise would be inconsistent with the exercise of the rights or restrictions proposed to be acquired by the undertaker on land shown coloured blue on these land plans.
4. All easements, servitudes and private rights are proposed to be suspended while the undertaker is in temporary possession of the land shown coloured green on these land plans.
5. The number labels relate to plot numbers. Please refer to the Book of Reference for more information about these plots, including the approximate area of each plot. Plot numbers include a reference to the relevant sheet of the Land Plans. In this numbering convention, a plot number comprises the sheet number followed by the actual plot number, e.g: Plot 01-24, where '01' is the sheet number.

Legend
 Order Limits
 Local Authority Boundary

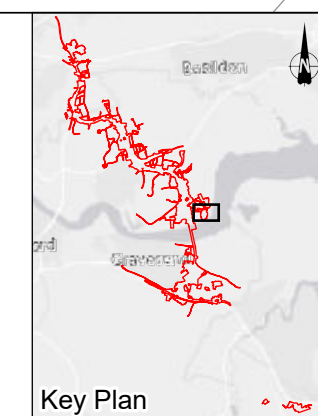

Client

 Project
LOWER THAMES CROSSING

Status	DCO Application	Original Size	A1	Revision	P01
Application Document Number	TR010032/APP/2.3	Scale	1:2,500		
Drawing Title	CROWN LAND PLANS REGULATION 5(2)(n) SHEET 19 OF 49				
Drawing Number	HE450039-CJV-BOP-ZZZ_BD000000_-DR-BL-20019				

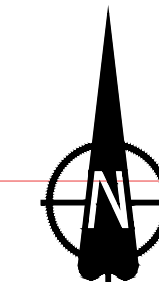

Local Authority:
Thurrock Council

Sheet 23
Sheet 20

**NO DESIGN INFORMATION ON THIS SHEET
FOR CROWN LAND PLANS**

Sheet 20
Sheet 19

East Tilbury
Marshes

Sheet 20
Sheet 16

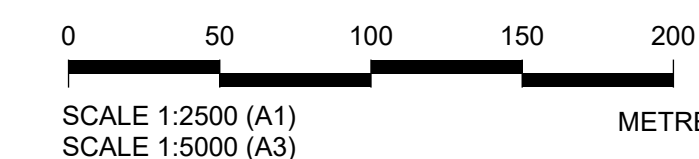

Crown copyright material is reproduced with the permission of Land Registry under delegated authority from the Controller of HMSO. This material was last updated in July 2022 and may not be copied, distributed, sold or published without the formal permission of Land Registry. Contains Ordnance Survey data. © Crown copyright and database rights 2022. Ordnance Survey 100030649

1. All dimensions are in metres unless stated otherwise.
2. These Land Plans should be read in conjunction with other plans and documents in the Development Consent Order application (TR020032/APP/3.1), in particular the Book of Reference (TR020032/APP/4.2).
3. All easements, servitudes and private rights in land are proposed to be extinguished on land shown coloured pink on these land plans. All easements, servitudes and private rights in land are proposed to be extinguished, so far as their continued exercise would be inconsistent with the exercise of the rights or restrictions proposed to be acquired by the undertaker on land shown coloured blue on these land plans.
4. All easements, servitudes and private rights are proposed to be suspended while the undertaker is in temporary possession of the land shown coloured green on these land plans.
5. The number labels relate to plot numbers. Please refer to the Book of Reference for more information about these plots, including the approximate area of each plot. Plot numbers include a reference to the relevant sheet of the Land Plans. In this numbering convention, a plot number comprises the sheet number followed by the actual plot number, e.g: Plot 01-24, where '01' is the sheet number.

- Legend**
- Order Limits
 - Local Authority Boundary

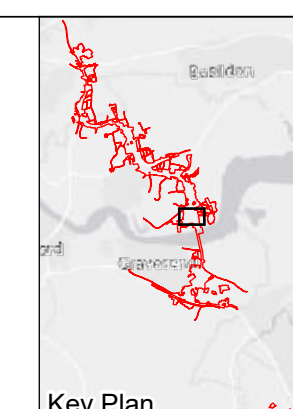

Client



Project
LOWER THAMES CROSSING

Status	DCO Application	Original Size	A1	Revision	P01
Application Document Number	TR010032/APP/2.3	Scale	1:2,500		
Drawing Title	CROWN LAND PLANS REGULATION 5(2)(n) SHEET 20 OF 49				
Drawing Number	HE450039-CJV-BOP-ZZZ_BD000000_-DR-BL-20020				

P01	S1	24/08/2022	Issued for Information	LS	AA	TG
Rev	Status	Rev. Date	Purpose of revision	Drawn	Chck'd	Apprv'd

If you need help accessing this or any other National Highways information, please call **0300 123 5000** and we will help you.

© Crown copyright 2022.

You may re-use this information (not including logos) free of charge in any format or medium, under the terms of the Open Government Licence. To view this licence:

visit www.nationalarchives.gov.uk/doc/open-government-licence/

write to the **Information Policy Team, The National Archives, Kew, London TW9 4DU**, or email psi@nationalarchives.gsi.gov.uk.

Mapping (where present): © Crown copyright and database rights 2022 OS 100030649. You are permitted to use this data solely to enable you to respond to, or interact with, the organisation that provided you with the data. You are not permitted to copy, sub-licence, distribute or sell any of this data to third parties in any form.

If you have any enquiries about this publication email info@nationalhighways.co.uk or call **0300 123 5000***.

*Calls to 03 numbers cost no more than a national rate call to an 01 or 02 number and must count towards any inclusive minutes in the same way as 01 and 02 calls.

These rules apply to calls from any type of line including mobile, BT, other fixed line or payphone. Calls may be recorded or monitored.

Printed on paper from well-managed forests and other controlled sources when issued directly by National Highways.

Registered office Bridge House, 1 Walnut Tree Close, Guildford GU1 4LZ

National Highways Company Limited registered in England and Wales number 09346363